

MINUTES OF JANUARY 5, 2021 COMMITTEE OF THE WHOLE MEETING
GLENCOE PARK DISTRICT
999 GREEN BAY ROAD, GLENCOE, ILLINOIS 60022

The meeting was called to order at 7:01pm and roll was called.

Committee Members present:

Lisa Brooks, President
Stefanie Boron, Vice President
Michael Covey, Treasurer
Josh Lutton, Commissioner
Dudley Onderdonk, Commissioner

Staff present:

Lisa Sheppard, Executive Director/Secretary
Carol Mensinger, Director of Finance/HR
Chris Leiner, Director of Parks/Maintenance
Bobby Collins, Director of Recreation/Facilities
Erin Classen, Supt. of Marketing/Communications
Jenny Runkel, Administrative Assistant

Members of the Public in attendance who signed in or spoke: Caleb Barth, Stephani Briskman, Brandon Hinkle, John MacManus, Bart Schneider, Adam Wohl

Matters from the Public: There were no matters from the public.

Discussion on Glencoe Beach Pier Re-Surfacing Concepts: Director Leiner indicated that Lake Michigan has given our beach a beating. Caleb Barth of Baird gave the presentation attached to these minutes. Mr. Barth indicated that Lake Michigan experiences periods of high and low water. Pier options include Alternative #1 – More Robust Decking Replacement (probable cost \$466,069) and Alternative 2 – Cast-In-Place Concrete Overlay Deck (probable cost \$225,675). Alternatives are meant to minimize the current issue of water trapped under the pier decking. Railing options include steel, which will need rust maintenance, or a more expensive polymer, which doesn't rust. Mr. Barth's scope did not include a structural assessment on the pier, which was completed a few years ago and was found to be structurally sound. These options are based on statistical analysis of 100 years of water level history and storm events. A six-inch increase should cover lake level rise in future. The project will begin in fall, as a spring project could impact the beach season. This study was focused on the decking, not on shore fortifications costing millions of dollars. During original dialogue at a previous meeting, the Board discussed and ended conversation on how fortifications would affect the look and feel at the beach and how it would look during low water level timeframes.

Discussion ensued on maintenance, the last capital investment in the early 90's, spending about \$70,000 last year to repair 60 feet at the end of the pier which lasted about 30 days before Lake Michigan removed it, insurance funds received for that damage, the pier protecting the swimming beach, the project will take approximately a month, boating beach stairs project scheduled for spring, the crib wall would be worked on in fall as well located on the ramp, and doing nothing would be a safety issue. If the Board decides to pass on this project (labeled option zero), the transition from asphalt to concrete would be removed and the railings would either be repaired or removed. A

ramp might also be required, requiring design work. The insurance payment for damage was reviewed.

Commissioner Lutton asked for gross cost, net cost, and insurance detail prior to the next discussion. Sheppard indicated it would be discussed next at the February meeting.

Commissioners gave feedback on the options including option two meeting the need, option one is more for aesthetics, and we currently have option one which didn't last.

Staff prefers option two, which has better aesthetics and durability and is also less expensive by about 50%. Staff will bring approximately three stamped concrete options to the Board for review, if this option is chosen. This project was approved for Year-One Capital Projects at the September 15 regular Board meeting and has \$225,000 budgeted in the FY2021/22 Budget going before the Board for approval in March.

The Lakefront Advisory Group will see a presentation on option two at their January 13 meeting.

Chair Brooks, after discussion and unofficial consensus from the Committee, directed staff to move forward with creating a Baird contract for option 2 to bring to the Board for approval at the February regular Board meeting.

Discussion on Contract Design Services for Lakefront Park Center Bluff Stabilization, Crib Wall Replacement, and Drainage: Sheppard indicated this project was approved by the Board as a Year One Capital Project. John MacManus of Altamanu explained the project of scope in a presentation attached to these minutes. Altamanu is the prime on the project, CBBEL is a consultant to Altamanu. This project includes the entire center of the bluff to Hazel and will protect the halfway house from storm water damage. Breaking up the project has the least disruption to the beach season, captures the COVID-19 bid environment, decreases the use of subcontractors, and targets the work to a specialized contractor as opposed to a general contractor. Discussion ensued including this project making future aesthetic improvements possible and that the Village and water plant staff attended meetings and are behind the project.

Chair Brooks, after discussion and unofficial consensus from the Committee, directed staff to advance approval of the design contract at the February Board meeting.

Update on Capital Fund Balance Projection: At the Board's request for more financial information prior to voting on the proposed Kalk Park Plaza Project, staff shared the approved Three-Year Capital Project list and explained that a number of our projects came very close to bid or significantly under due to the aggressive COVID-19 bid market. Staff came up with the financial outlook when this round of projects are completed and indicated what would have to change if the District moved forward with the plaza and what future projects could be incorporated down the line.

We will receive grant funds from the IDNR or OSLAD, but have not received them yet. Over \$600,000 in project savings was realized. Staff are confident that the District can afford to pay for this project.

Other Business: The Duke Park construction fence came down over winter break and the park is open. There will be a small dedication with the Zirlin family as soon as their plaque arrives. We hope to have a bigger dedication in the spring when the interactive fountain and train are operating.

The Connect Glencoe project is almost complete, the social spaces arrived and will be installed in spring once the foundations are installed. We received a \$14,200 donation yesterday for the Circles social space, benches, and a picnic table with a total of approximately \$30,000 in donations for the Linear Trail project.

Following brush removal, the Veterans Park trail gateway wall revealed to be falling apart. The allowance in the bid of \$10,000 for limited tuck-pointing and repairs will not cover the wall, however 80% of the wall will be covered by state funding under the grant. The District will only need to spend \$4,000 for \$40,000 worth of work. In spring, the wall will be disassembled, photographed, and put back together with the same stones using modern construction techniques.

We are already seeing incredible use of Duke Park. There is a substantial punch list of repairs to be done in spring including regrading, crooked benches, deer prints in the concrete, etc.

Adjourn: Commissioner Lutton moved to adjourn the meeting at 8:26pm. Commissioner Boron seconded the motion, which passed by unanimous voice vote.

Respectfully submitted,

Lisa M. Sheppard
Secretary

Mr. Chris Leiner
Director of Parks and Maintenance | Glencoe Parks District
999 Green Bay Road
Glencoe, IL 60022

via email to cleiner@glencoeParkDistrict.com

Status: Draft
December 11, 2020

Reference # 13359.101.L2.RevA

RE: GLENCOE PIER DECK REPLACEMENT CONCEPTUAL DESIGN

Dear Mr. Leiner,

Introduction

W.F. Baird & Associates Ltd. (Baird) is providing conceptual design services to the Glencoe Park District (Park District) for the repair/replacement of the Glencoe Beach pier deck in Glencoe, IL. Two conceptual alternatives were developed and are presented in this letter for the Park District's consideration.

The conceptual alternatives were developed with the criteria outlined in the previously issued Basis of Design (BoD) (reference 13359.101.L1.RevA).

Conceptual Design

Deck Replacement Alternatives

The low elevation of the pier exposes the deck to severe environmental forces during periods of moderate to high water levels on Lake Michigan. Two alternative concepts were developed and evaluated, as summarized below. Conceptual sketches for each alternative are provided in **Attachment 1**. The evaluation of the alternatives was based upon a number of factors, including aesthetics, environmental impact, functionality, durability/resiliency, regulatory requirements, opinion of probable construction cost, construction duration, and maintenance requirements.

Alternative 1 – More Robust Decking Replacement

The Alternative 1 deck surface consists of composite decking. Notable features of Alternative 1 are as follows:

- Demo remaining asphalt overlay, existing perimeter angle, HSS handrail sleeve, and handrail. Preserve and protect the steel sheet pile channel cap.
- Install new pier perimeter angle and HSS sleeve.
- Place concrete overlay, minimum 3.5" thick, to level pier deck surface.

- Pressure wash existing pier concrete cap to develop bond with new concrete overlay. The layer between the existing concrete cap and the new overlay shall be designed for bonded behavior according to ACI 325.13R-06.
- General structural condition of the existing concrete cap and the new concrete overlay shall be assessed prior to installing the new concrete overlay. Deteriorated cracks, joints, and/or punchouts shall be repaired.
- Concrete compressive strength of 4,000 psi (28 days).
- Concrete overlay according to ACI 325.13R-06. Reinforcement (Welded wire or rebar) shall be added if active cracks are found in the existing concrete cap. The addition of fibers to the overlay might also be considered.
- Saw-cut joints designed according to ACI 360R-06 shall be used in the concrete overlay for crack control. Joints in the overlay shall also match and existing joints in the concrete cap.
- To provide adequate drainage, the concrete overlay shall include v-shaped drainage grooves with a 1% slope. The use of v-shaped blockouts might also be evaluated.
- Install 4x4 sleepers, anchor to pier concrete surface with brackets and post-installed concrete screw anchors:
 - Structural steel shapes and plates shall conform to ASTM A36.
 - Connection elements shall be hot-dip galvanized after fabrication.
 - Hot-dip galvanized ASTM A307 bolts shall be used to attach the sleepers to the sleeper brackets.
 - Stainless steel screw anchors shall be one of the following or approved equivalent:
 - Simpson stainless steel Titen HD screw anchors.
 - Hilti KWIK HUS-EZ SS316 stainless steel screw anchors.
- Install HDPE decking:
 - Weardeck, Lumberock, or approved equivalent HDPE Boards shall be used for the decking and sleeper system. Product literature for each is provided in **Attachment 2**.
 - Appropriate end-to-end and side-to-side spacing shall be provided between deck boards to account for thermal expansion, drainage, debris removal, and/or air circulation.
 - Simpson Strong-Tie Deck-Drive DCU composite screws or approved equivalent shall be used to attach the deck boards to the sleepers.
 - Minimum 2 screws shall be used at each board-sleeper intersection.
- Install new handrail and replace light fixtures.
- Top of deck elevation shall be increased by approximately 0'-6".

Alternative 2 – Cast-In-Place Concrete Overlay Deck

The Alternative 2 deck surface consists of a stamped concrete overlay. Notable features area as follows:

- Demo remaining asphalt overlay, existing perimeter angle, HSS handrail sleeve, and handrail. Preserve and protect the steel sheet pile channel cap.
- Place concrete overlay, minimum 5" thick, to level/slope pier deck surface:
 - Pressure wash existing pier concrete cap to develop bond with new concrete overlay. The layer between the existing concrete cap and the new overlay shall be designed for bonded behavior according to ACI 325.13R-06.

- General structural condition of the existing concrete cap and the new concrete overlay shall be assessed prior to installing the new concrete overlay. Deteriorated cracks, joints, and/or punchouts shall be repaired.
- Concrete compressive strength of 5,000 psi (28 days).
- Reinforcing steel shall be deformed steel bars conforming to ASTM A615 – Grade 60. Minimum rebar for crack control according to ACI 360R-06. Two layers of rebar steel might be needed where overlay thickness exceeds 8 inches.
- Smooth dowels shall conform to ASTM A615 – Grade 60. Doweled expansion joints shall be provided at appropriate locations (TBD).
- Joint protection (sealing and filling) according to ACI 360R-06.
- Stamped and/or colored finishing shall follow the recommendations given in ACI 310R-13. See **Attachment 3** for example stamp patterns.
- The finished surface shall have a 1% (or 1/8" per foot) slope to provide adequate drainage.
- Install new handrail and replace light fixtures.
- Top of deck elevation shall be increased by approximately 0'-3".

Evaluation of Alternatives

Table 1 presents a matrix comparison of the two alternative concepts. The alternatives have been ranked relative to one another under various factors to facilitate the Park District's identification of a Preferred Alternative. The evaluation criteria included the following:

- Aesthetics – physical appearance / how well the alternative will match the overall ambiance of the existing Lakefront Park and Glencoe Beach structures;
- Environmental impact – the pollution and energy consequences of the manufacturing/production process of the primary materials;
- Functionality – slipperiness, thermal comfort, and wearability;
- Durability / Resiliency – ability to survive and recover from severe storm events;
- Regulatory requirements – complexity of the regulatory process to gain approval for the construction of the project;
- Opinion of probable construction cost – itemized cost estimate detail is provided in **Attachment 4**;
- Construction duration – how long construction will impact the use of the pier; and
- Maintenance requirements.

Table 1: Matrix Comparison of Alternatives

Evaluation Factor	Alt. 1	Alt. 2	Notes
Aesthetics	G	S	<ul style="list-style-type: none"> • Composite decking is often preferred for its aesthetics over a concrete overlay (positive for ALT 1). • The concrete surface could be stamped with a flagstone pattern to align with other structures in the park. (positive for ALT 2)

Evaluation Factor	Alt. 1	Alt. 2	Notes
Environmental Impact	G	S	<ul style="list-style-type: none"> Composite products are often created from recycled plastics. (positive for ALT 1) Manufacturing cement results in high levels of CO2. Sourcing aggregate/sand locally often minimizes further impacts to the environment. (negative for ALT 1 & 2)
Functionality	G	G	<ul style="list-style-type: none"> Composite decking retains heat more rapidly than concrete (positive for ALT 2) Composite decking is more flexible to foot traffic. (positive for ALT 1)
Durability / Resiliency	G	E	<ul style="list-style-type: none"> Alternative 2 has fewer modes of failure / damage that could be caused by the environment. (positive for ALT 2)
Regulatory Requirements	G	G	<ul style="list-style-type: none"> Both alternatives will have the same regulatory requirements; the regulatory requirements were defined in the BoD.
Opinion of Probable Construction Cost (OPCC)	P	G	<ul style="list-style-type: none"> The Alternative 1 OPCC exceeds the available budget; the durability of the system (i.e., minimize sleeper size and anchoring) could be adjusted/minimized to decrease the OPCC. The Alternative 2 OPCC meets the available budget.
Construction duration	S	G	<ul style="list-style-type: none"> The construction duration for ALT 1 will be longer than ALT 2. (positive for ALT 2)
Maintenance	S	E	<ul style="list-style-type: none"> Composite decking has been known to sag/warp unpredictably following installation. (negative for ALT 1) The cast-in-place concrete overlay should require minimal maintenance with proper construction QC/QA and expansion/control joint details. (positive for ALT 2)

Note: E=Excellent, G=Good, S=Satisfactory, P=Poor

Conclusion

The proposed pier deck replacement alternatives were developed to meet the owner's requirements and design criteria outlined in the BoD document with a goal of improving the durability of the pier deck and minimizing future maintenance requirements.

Baird recommends that the Park District review the information provided in the conceptual design letter and provide feedback and guidance on the desired improvements. The feedback and guidance provided will form the basis for the design development of the preferred alternative in the next phase of the work.

We appreciate the opportunity to work with the Park District on this project. Feel free to give me a call at 608-515-4587 with questions.

Best regards,



Caleb Barth | Marine Engineer
Baird & Associates
E: cbarth@baird.com

CC: Jamie Briones

Attachments:

- 1 - Conceptual Sketches
- 2 - Decking Product Literature
- 3 - Stamped / Colored Concrete Options
- 4 - Opinion of Probable Construction Cost

Attachment 1 - Conceptual Sketches

IN PROGRESS
DRAFT

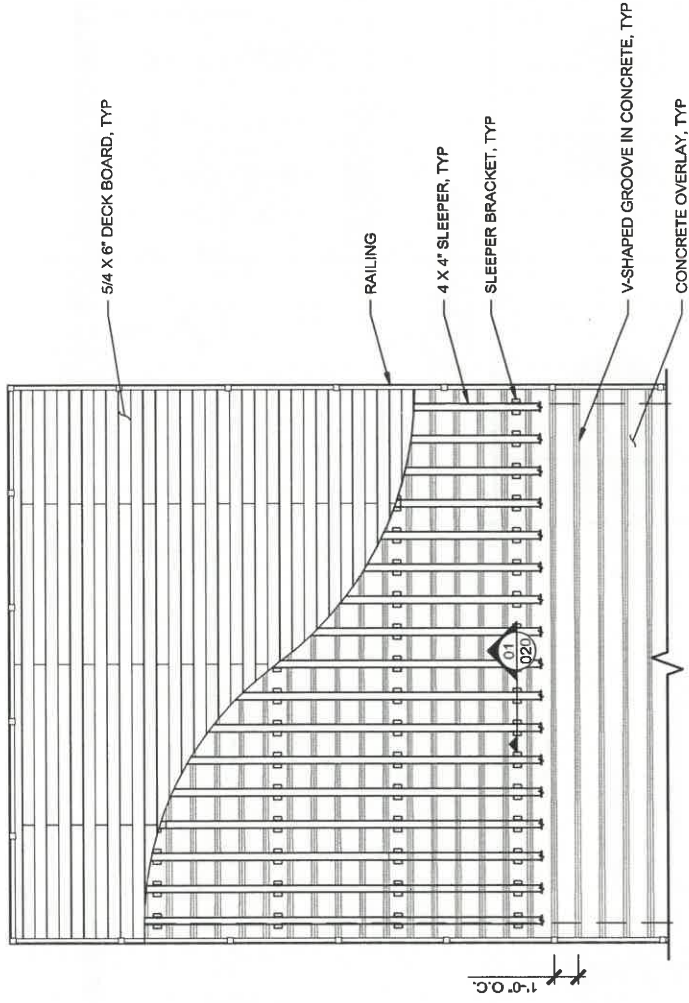

ALTERNATIVE 1 PLAN VIEW

GLENCOE BEACH PIER DECK REPAIR

Project Number:
13359.101

DATE:
2020-12-11

Baird.

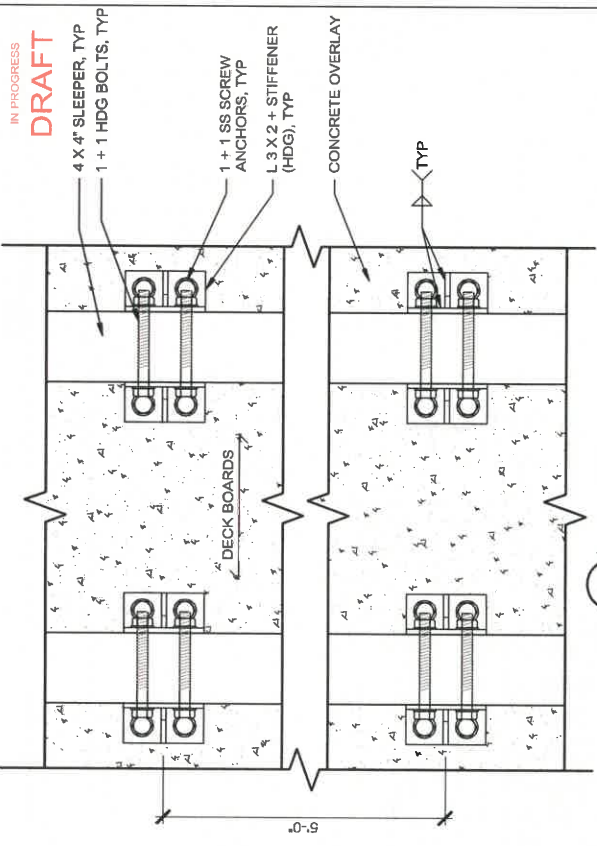

NOTE: DECKING AND EXISTING CONCRETE NOT SHOWN FOR CLARITY.

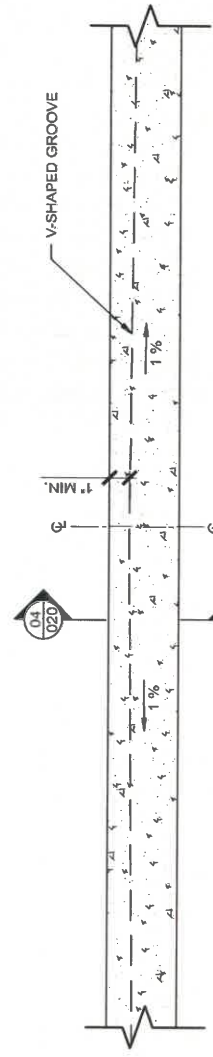

NOTE: DECKING AND EXISTING CONCRETE NOT SHOWN FOR CLARITY.

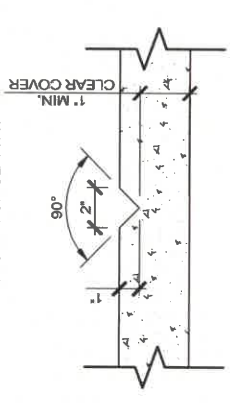

IN PROGRESS
DRAFT

- 4 X 4" SLEEPER, TYP
- 1 + 1 HDG BOLTS, TYP
- 1 + 1 SS SCREW ANCHORS, TYP
- L 3 X 2 + STIFFENER (HDG), TYP
- CONCRETE OVERLAY
- TYP

ALTERNATIVE 1 DETAILS

GLENCOE BEACH PIER DECK REPAIR

IN PROGRESS
DRAFT

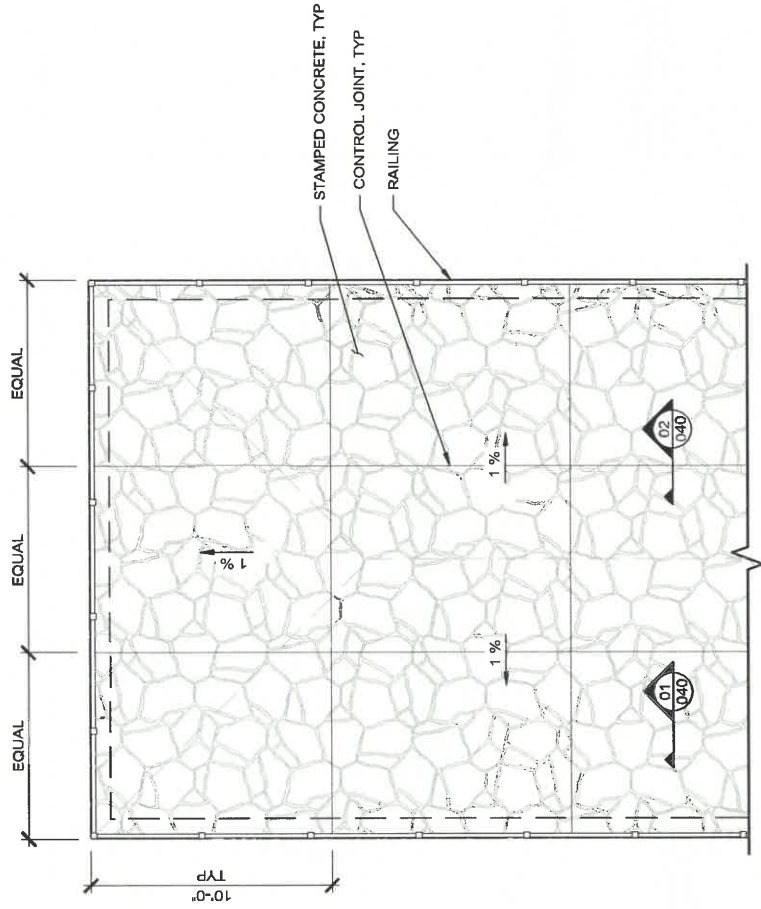

ALTERNATIVE 2 PLAN VIEW

GLENCOE BEACH PIER DECK REPAIR

PROJECT NUMBER:
13359.101

DATE:
2020-12-11

Baird.

IN PROGRESS
DRAFT

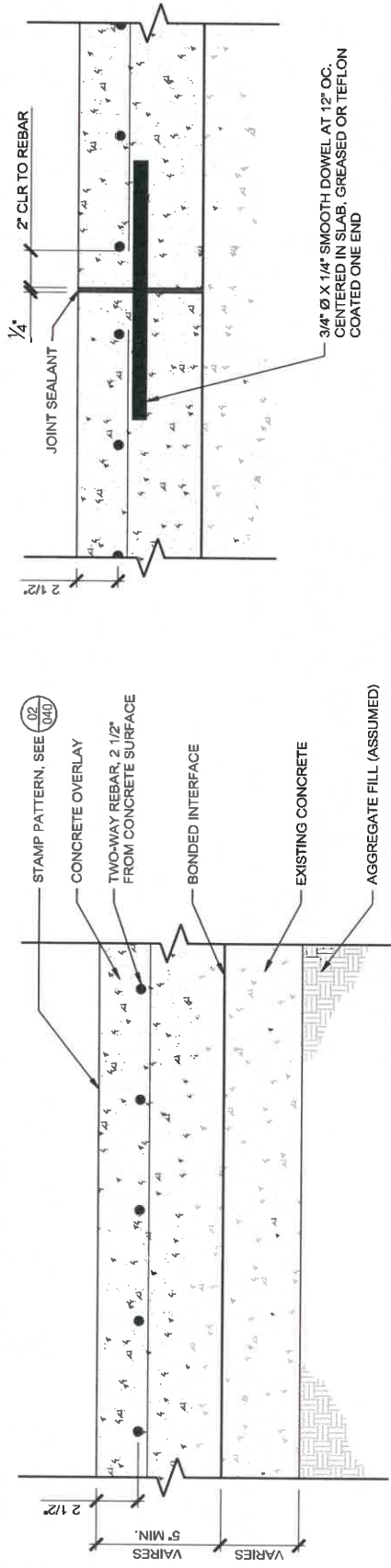

01 STAMPED CONCRETE CROSS SECTION
SCALE: 1" = 6"

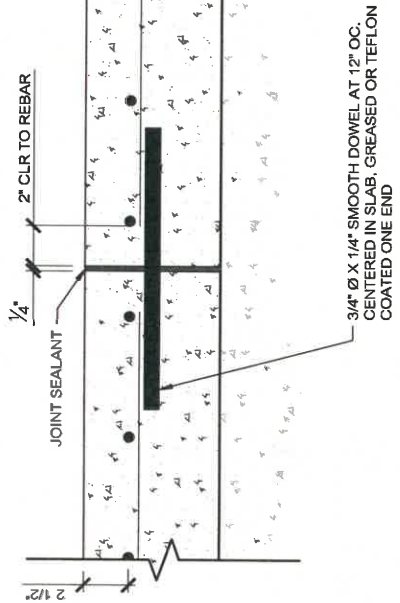

02 TYPICAL EXPANSION JOINT DETAIL
SCALE: 1" = 6"

NOTE: IF DEEPER STAMP PATTERN IS REQUIRED, MINIMUM CONCRETE OVERLAY THICKNESS NEEDS TO BE CHECKED.



03 STAMP PATTERN DEPTH DETAIL
SCALE: 1" = 6"



ALTERNATIVE 2 DETAILS

GLENCOE BEACH PIER DECK REPAIR

Attachment 2 - Decking Product Literature



A SMART INVESTMENT

It's true that Lumberock® costs more up front than traditional wood products, however our synthetic lumber will never crack, rot, splinter or peel, and docks built with Lumberock® require minimal maintenance. Unlike traditional wood which requires bi-weekly sanding and staining — a time-consuming and expensive process. Within two years of having a Lumberock® deck or dock, you will have recouped your investment and saved yourself hours of labor.

Cost of Lumberock® vs. Cost of Wood



CLEANING & CARE

One of the primary advantages to using Lumberock® is that the boards require almost no maintenance whatsoever after their installation. When dirt or debris begin to accumulate on your deck or dock, simply sweep it away, huck it off or lightly wash the boards with soap and water. Any standard household cleaner can be used. Occasionally, mildew and mold will form on dirt that has built up on the boards, but it will not permeate the surface of the board and can be removed with a light pressure washing. Additionally, stains from food, oil, beverages and grease will not adhere Lumberock® Premium Decking.



WE ROCK – HERE'S WHY

Completely Synthetic Deck/Dock Boards

Lumberock® uses innovative extrusion technology to combine a mineral-filled composite with high density polyethylene plastic. This formula allows us to manufacture solid non-porous, dimensional profiles that are extremely durable and that will not crack, splinter or peel. Because no organic fill is used, there is nothing for mold or mildew to adhere to and nothing for water to soak into. Bacteria, insects and other organisms that thrive in areas with outdoor exposure and lots of moisture cannot permeate the surface or interior of the board. Lumberock® can endure prolonged submersion in saltwater and freshwater and is covered by our Limited Lifetime Warranty even in these conditions. Additionally, our boards feature increased strength and decreased thermal expansion due to our use of a mineral fill additive.

Traditional Installation

Lumberock® requires no special tools for installation. Standard carpentry tools will do the trick and no pre-drilling is necessary. All of our boards feature rounded edges to help hide straight line imperfections sometimes caused during installation.

Lumberock® should be fastened to the dock frame using standard fastening systems, such as stainless steel screws. For 2x6 dock and dock boards, we recommend a fast spacing of 16" on centers for residential projects and 12" on centers for commercial/dock projects. For 2x8 and 2x8 dock and dock boards, we recommend a fast spacing of 24" on centers for residential projects and 18" on centers for commercial/dock projects.



IDEAL FOR WATERFRONT APPLICATIONS

Authorized Distributor/Dealer

Lumberock® Premium Decking
885 Church Road, Elgin, IL 60123

Visit lumberock.com or call 800-480-2327

Find us on Facebook at
www.facebook.com/lumberock

A product of ENGINEERED PLASTIC SYSTEMS, LLC

EPS118104/17 ©2017 Lumberock® Premium Decking





Solid!

Lumberock® is a synthetic dimensional lumber made from the unique combination of HDPE plastic and a natural mineral fill material.

- › Increased Strength & Durability
- › Minimal Maintenance
- › Easy to Install
- › No Permanent Staining
- › Completely Waterproof
- › No Organic Fills or PVC
- › No Noticeable Fading
- › Natural Wood-Grain Pattern
- › Will Never Rot, Crack or Splinter
- › High Performance
- › Mold & Mildew Free
- › Impenetrable Surface
- › Cuts & Routers Like Wood



Lumberock® is engineered to withstand harsh, wet environments making it the ideal choice for your dock, marina, boardwalk or swimming pool project.

Available Colors



DOCK PROFILES

5/4 x 6 DOCK BOARD



Actual Dimensions:
1" x 5.5" (2.5cm x 14cm)
Lengths:
12ft, 16ft, 20ft

2 x 6 DOCK BOARD



Actual Dimensions:
1.5" x 5.5" (3.8cm x 13.7cm)
Lengths:
12ft, 16ft, 20ft

2 x 8 DOCK BOARD



Actual Dimensions:
1.5" x 7.5" (3.8cm x 19cm)
Lengths:
12ft, 16ft

1 x 10 TRIM BOARD



Actual Dimensions:
0.75" x 9.5" (1.9cm x 24cm)
Lengths:
8ft

1 x 1-1/2 PILING STRIP



Actual Dimensions:
0.75" x 9.5" (1.9cm x 3cm)
Lengths:
8ft

BACKED BY OUR

LIMITED LIFETIME WARRANTY

Product Information and Installation Guide



Product Information and Installation Guide

Product Composition:

High Density Polyethylene (HDPE) resin and a proprietary blend of additives including pigments, UV inhibitors, and AO stabilizers.

Product Features and Benefits:

- Highest Live Load Capacity Ratings in the industry
 - Our 5/4x6" board supports 120 lbs/SqFt at 24" O.C.
 - Requires less understructure
- Heat Reflective
 - Reduces our boards surface temperatures by 30 percent
 - New Barefoot colors stay cool for bare feet
- 8 vibrant colors in a bold wood grain, slip-resistant finish:
 - Cool Gray, Sand, Cedar, Weatherwood, Saddle, White, Barefoot Grey, Barefoot Sand
 - Maximum color retention with 25-year UV package
- 25-year Commercial Warranty and Lifetime Residential Warranty
- Custom cut-to-order program reduces waste, cost and labor
- Available in up to 28 ft. lengths (industry exclusive)
- Minimal thermal expansion & contraction
 - Maximum of 1/32" on a 20' board
- Easy to maintain
 - Clean with soap and water or a pressure cleaner at a safe distance
- Weatherproof and Waterproof
 - Withstands harsh heat, hurricanes and saltwater
- Rated for ground contact and underwater installation
- No mold or mildew
- Easy for builders to use
 - Rip, edge and route our product
 - Core color matches skin



Decking Profiles:

Standard Deck Board 5/4x6"

Actual Dimensions: 1.05x5.5"

Standard Lengths: 12' 16' 20'

Custom Lengths: Up to 28'

Woodgrain: One Side

Colors Available: All

Standard Deck Board 5/4x8"

Actual Dimensions: 1.05x7.25"

Standard Lengths: 12' 16' 20'

Custom Lengths: Up to 28'

Woodgrain: One Side

Colors Available: All

Standard Deck Board 2x6"

Actual Dimensions: 1.35x5.5"

Standard Lengths: 12' 16' 20'

Custom Lengths: Up to 28'

Woodgrain: One Side

Colors Available: All



Standard Deck Board 2x4"

Actual Dimensions: 1.5x3.5"

Standard Lengths: 16' 20'

Custom Lengths: Not available

Woodgrain: Both Sides

Colors Available: All

Standard Deck Board 2x8"

Actual Dimensions: 1.5x7.25"

Standard Lengths: 12' 16' 20'

Custom Lengths: Not Available

Woodgrain: Both Sides

Colors Available: All colors at 12' and 16'. White, Cedar, and Saddle at 20'.

Standard Deck Board 2x10"

Actual Dimensions: 1.5x9.25"

Standard Lengths: 12' 20'

Custom Lengths: Not Available

Woodgrain: Both Sides

Colors Available: All colors at 12'. White, Cedar, and Saddle at 20'.

Standard Deck Board 1/2x6"

Actual Dimensions: 0.5x5.5"

Standard Lengths: 18'

Custom Lengths: Not Available

Woodgrain: Both Sides



Colors Available: All

Standard Deck Board 1/2x10"

Actual Dimensions: 0.5x9.5"

Standard Lengths: 12'

Custom Lengths: Not Available

Woodgrain: Both Sides

Colors Available: All

Custom Lengths:

Our Custom Cut-to-Order Program provides customers the opportunity to purchase custom length boards up to 28ft at no additional cost. Reduce waste, labor, and time on the job.

Profiles offered: 5/4x6", 5/4x8", and 2x6"

Minimum: 800 linear feet per cut.



Standard Decking Bundle: Sizes and Weights

Use these standard bundle quantities and weights for calculating truckloads. Truckload orders are approximately 44,000lbs or at least 18-21 pallets. Use weights for orders of standard lengths and weight per foot to calculate total weights for Custom Cut to Length Program orders. If you need 12 or 20' lengths, it is possible to order full bundles.

Profile	PCS/Bundle	12' wt per Bundle	16' wt per Bundle	20' wt per Bundle	Wt per Ft
5/4 X6"	64	1459 lbs	1946 lbs	2432 lbs	1.90 lbs
5/4 X8"	48	1475 lbs	1966 lbs	2458 lbs	2.56 lbs
2 X 4"	36	N/A	968 lbs	1210 lbs	1.68 lbs
2 X 6"	40	1162 lbs	1549 lbs	1936 lbs	2.42 lbs
2 X 8"	30	1296 lbs	1728 lbs	2160 lbs	3.60 lbs
2 X10"	25	1335 lbs	N/A	2225 lbs	4.60 lbs
1/2 X6"	64	Available in bundles of 18 ft @ 1037 lbs			0.90 lbs
1/2X10"	48	Available in bundles of 12 ft @ 979 lbs			1.60 lbs



BASIC INSTALLATION INFORMATION:

WearDeck Reinforced Polymeric Lumber in all profiles produces decking that easily exceeds generally accepted standards for application.

1. 5/4" decking spans 24 inches on center (O.C.) for deck and dock applications.

Live Load Capacity:

266 lbs./ft² at 16" O.C.

120 lbs./ft² at 24" O.C.

2. 2" x 6" decking spans 24 inches O.C. for deck and dock applications.

Live Load Capacity:

306 lbs./ft² at 24" O.C.

Joist Spacing:

WearDeck is designed to perform above accepted standards at the 24" on center spacing as indicated above. However, using the generally accepted decking joist spacing standards provides an installation far superior to any competitor. We recommend the installation guidelines below for exceptional performance.

5/4 x 6" joists spacing

16" on center

12" on center if installed diagonally. Commercial applications are generally a minimum of 12 inches on center

(Always refer to the overriding local building code requirements)

2 x 6" joists spacing



24" on center

16" on center if installed diagonally. Commercial applications are generally 16" on center, possibly 12" for straight commercial applications. (Always refer to the overriding local building code requirements)

For commercial applications, **ALWAYS** follow local municipal building code standards for ALL commercial installations, which generally require closer joist spacing by applicable code.

Check Your Joists:

- All joists must be level to each other in order to attain a proper quality installation. **This is responsibility of the homeowner, builder or contractor.**
- Joists may require blocking/bridging in order to maintain straight and level joists based on material used to construct deck. **This is the responsibility of the homeowner, builder or contractor.**
- For cantilevering; 5/4" x 6" maximum of 2" & 2 x 6" maximum of 4".
 - Provide a minimum of a 1/8" to 1/4" inch gap between exterior walls, pilings, posts, & retaining walls or any solid fixed structure when installing all decking. This is to accommodate any potential movement of main structures (walls, pilings, posts etc....) not the deck board.
 - WearDeck's unsurpassed strength & stability adds significantly to the structural stability of any deck or dock structure, when properly applied.
 - WearDeck has a directional grain pattern, which for appearance purposes **ONLY** is best applied with the 5 grain peaks on board face running in the same direction. Wood grain pattern repeats every 37.5 inches.

FASTENING & WORKABILITY:

WearDeck works well with a variety of fastening options listed below. We recommend building with Stainless Steel Composite Deck Screws. Stainless Steel Composite Deck Screws offer exceptional longevity and appearance as they capture surface material. Screws that are not designed specifically for



composite deck boards will not provide the best or proper appearance at the board's surface.

Examples of Acceptable Fasteners:

1. Starborn, Simpson Strong-Tie, Deckmate, TrapEase by Fasten Master, Tiger Claw, etc.
2. We recommend CAMO for excellent for drive tools and concealed fastening applications. As with use on any decking application, concealed fastening methods do not provide as strong of an application as face fastening.

Fastening Recommendations:

When face fastening a 5/4" board, use at a minimum, a #9 x 2 1/2" exterior rated composite type screw.

3. When face fastening a 2" board, use at a minimum, a #10 x 2 3/4
4. " exterior rated composite type screw.
5. Predrilling is NOT GENERALLY REQUIRED, however in the extreme cold of winter, testing to determine best method of application is recommended.
6. WearDeck can be installed with standard tools used for installing any wood deck or dock.
7. A MINIMUM of 2 fasteners should be placed from 1/2 to 1 inch from ends & edges of decking at a minimum of every 24 inches or every joist for proper standard decking applications. Your particular application may require a more fasteners based on needs of your structure. Applications for other than standard decking use, example 2x8s or 2x10s, may require special bolts or screws based on your particular application or structures needs.
8. 1/2" x 6" or 1/2" x 10" Fascia is designed for use as trim over a completely solid, level boardto board, surface. WearDeck Fascia is not designed to be used as decking, decking cap or any walkable wear surface or to span any distance without solid level board-to-board support.



When used properly, as designed for fascia or trim purposes, should be installed as indicated below:

- A. $\frac{1}{2}$ " x 6" should be fastened with a minimum of 2 screws every 12 inches starting at 1" from ends and edges of each board, allowing $\frac{1}{16}$ " inch gap between ends / butt joints of each board, screw should be at least a #8 x 1 5/8" long. Example of cap capture screw would be; Deckmate #8 x 1 5/8" T20 star drive composite
- B. $\frac{1}{2}$ " x 10" should be fastened with a minimum of 2 screws every 12 inches applied vertically starting at 1" from ends and edges of each board, allowing $\frac{1}{16}$ " inch gap between ends of each board, screw should be at least a #8 x 1 5/8 inches long. Example of cap capture screw would be; Deckmate #8 x 1 5/8" T20 star drive composite.
- C. Screws can be composite deck type screw with cap capture threads or standard style threads, cap capture style screws provide the best appearance.

*** MINIMUM requirements stated above but **Fastening & fastener decisions are entirely the responsibility of the homeowner, builder or contractor.**

DECK SPACING GUIDELINES:

WearDeck provides the most stable composite decking board on the market today. Because of our strenuous manufacturing standards, WearDeck outperforms any known product in the industry today, particularly in terms of thermal expansion and contraction tolerance during the extreme heat of summer or the extreme cold of winter.

Thermal Expansion = $\frac{1}{32}$ " in the length of a 20' 5/4 x 6" or 2 x 6" deck board

This allows for generally unheard of spacing requirements:



- End to end spacing minimum of 1/16 inch.
- Side to side spacing minimum of 1/16 inch. *

*General building practices call for wider side to side spacing to allow for proper drainage, debris removal and/or air circulation, PLEASE consider these factors when installing any decking material. WearDeck is rated for ground contact and can be installed underwater.

FACE FASTENING GUIDELINES:

Even with WearDeck's superior characteristics we recommend using the most commonly accepted fastening methods. Use of a quality composite decking style screw is recommended for best performance and appearance.

1. Straight at 90° to deck board.
2. When face fastening place screws NO closer than ½ inch from the end and ½ inch from the side from side edge of deck board, using 2 screws at each joist connection. Builders most often find that installing screws approximately 1" from end and edges of boards provides a better look and overall optimal application.
3. A MINIMUM of 2 fasteners should be placed from ½ to 1 inch from ends & edges of decking at a minimum of every 24 inches or every joist for proper standard decking applications. Your particular application may require a more fasteners based on needs of your structure. Applications for other than standard decking use, example 2x8s or 2x10s, may require special bolts or screws based on your particular structures needs.
4. MINIMUM requirements are stated but ALL **Fastening & fastener decisions are the responsibility of the homeowner, builder or contractor.**

CLEANING:

Generally keeping the decking surface rinsed to remove excess dirt and debris will keep surface in excellent condition. We recommend periodic cleaning for the best overall appearance.

1. Promptly clean any stain with a good household cleaner and a natural bristle brush.



2. However, if dirt is allowed to build up on the surface for a prolonged time tougher buildup may occur which could require extra effort to remove.
3. WearDeck has NO organic compounds so WearDeck will not support mildew or mold growth but if allowed to become and stay dirty the dirt, soil, debris will grow mold or mildew, requiring extra effort to clean. Again, standard cleaning practices will keep your WearDeck beautiful for years.
4. Cleaning solutions such as; DAWN dishwashing solution, 409, Simple Green, Fantastik, etc. should work well for general cleaning needs.
5. IF there is a grill on the deck, a non-rubber backed mat is recommended to protect against grease drops. If grease stains or any stain occurs they should be cleaned as soon as possible. The longer they remain the harder they are to remove from any surface / any product. DAWN dishwashing solution generally does an excellent job removing most grease stains.
6. Pressure Washing is **NOT RECOMMENDED**. However, if pressure washer is used always keep spray tip from 12 to 18 inches away from deck material with a wide fan spray setting at medium pressure. **NEVER** use a fine point spray setting when cleaning any plastic, composite or wood decking material, as fine point spray on a pressure washer can and will most often damage any decking material regardless of type.

RE-DECKING AN OLD DECK OR DOCK:

IMPORTANT: When re-decking an old deck or dock after removal of old surface material it is necessary that the remaining structure be properly inspected, re-nailed and/or re-screwed. Boards should be replaced where necessary before new decking can be installed on what then should be a secure deck structure that is very importantly, level board to board.

This is the responsibility of the homeowner, builder or contractor.



Attachment 3 Stamped/Colored Concrete Options

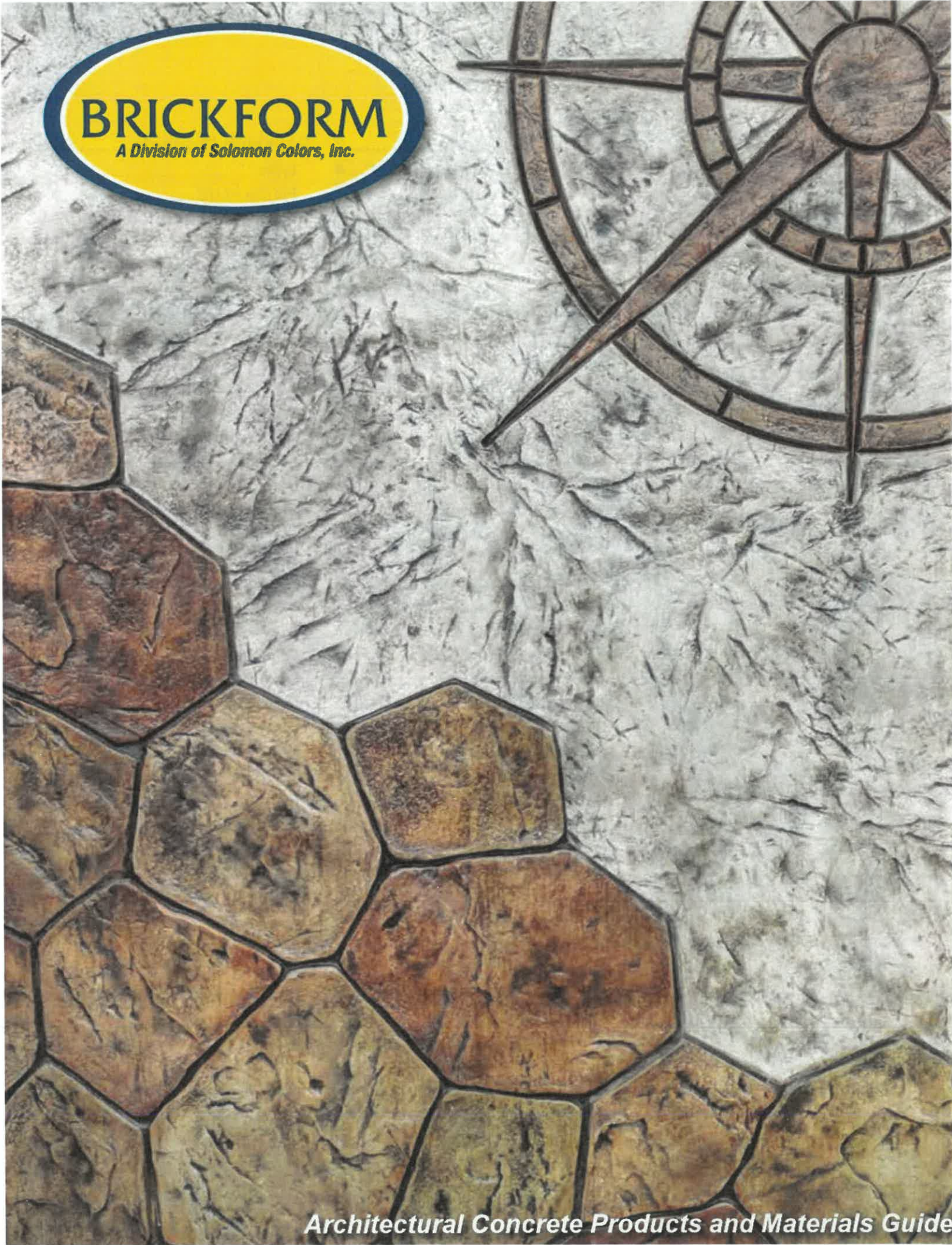



Find a Local Distributor

1-800-483-9628

8:00a to 6:00p CST

Monday-Friday

Technical Service

1-833-45COLOR

(1-833-452-6567)

More Information Online

www.Brickform.com

www.solomoncolors.com



Table of Contents

Why Buy Brickform? 3

Web/Training & Stamp App... 4

Texturing Products 5-67

 Seamless Texture Skins 5-15

 Concrete Dimensions Stencils 16-21

 Paladiano Texture Mats 22-28

 Stone Texture Mats 29-42

 Slate Texture Mats 43-47

 Brick Texture Mats 47-49

 Wood Texture Mats 50-53

 Tile Texture Mats 54

 Border Tools 55

 Creative Images Texture Mats 56-59

 Contractors Choice 60

 Gang Tools 61

 Overlay Texture Mats 62

 Cal-Trans Series Texture Mats 62

 Graphic Warning Texture Mats 62

 Ultra-Liners 63

 Step-Liners 64-65

 Paper Stencils 66-67

 Imprint Tools 68

 Texturing Accessories 69

Coloring Products 70-87

 Color Hardener 70-71

Sample Combinations foldout

 Antique Release 72-73

 FreestylePRO 74

 Cem-Coat 75

 Antique-It 76

Standard Color Selection Guide

 DAY1 77

 Liquid Release 78

 MagVibe 78

 Surface Deactivator 79

 Brickform Powdered Color 80

Powdered Integral Color Card

Solomon Dry Pigment

Ready Mix Color Card

 Solomon Colors Powdered Color 81

 Blush-Tone Acid Stain 82-83

 E-Stain 84-85

 ARTesian Stain 86-87

Polishing Products 88-91

 Lythic 88-89

 Pro Dye *PLUS* 90-91

Finishing & Maintenance 92-93

 E-Etch 92

 Evaporation Retarder 92

 Neutra Clean 92

Resurfacing Products ... 94-103

 Stampable Overlay 94-95

 Micro-Topping 96-97

 SM Professional Grade 98-99

 Vertical Mix 100-101

 Triple Seven Bond Coat 102

 Overlay Liquid Colorant 102

 Turtle Set 102

Sealers 104-109

 UreMax WB 104

 Poly-Astic 104

 DecoPoxy 104

 Stealth-Seal 104

 Stealth-Seal Premium 104

 Gem Cure & Seal 105

 Satin Cure & Seal 105

 Gem-Seal 106

 Poly-Seal 106

 NEW Poly-Tint 106

 Safety-Seal 106

 Satin-Seal 107

 Strip-It 107

 Premium Acrylic Floor Finish 107

 Tinta' Seal 108

 Traction Grip 108

 Matte-Magic 108

 Sealer Properties Checklist 109

Systems Approach to Decorative Concrete.. 110-111

Seamless Skins

Brickform Seamless Skins™ are feathered-edged skins that produce continuous texture with no grout or joint lines. Brickform texture skins are available in ultra-flexible, classic flex, and standard flex materials, all designed with unsurpassed quality. Seamless skins are compatible with Brickform Stampable Overlay.



Rough Stone Texture (C)

A natural stone texture characterized by a continuous coarse surface with several distinguishing veins.

See page 15 for ordering information.



Blue Stone Texture (A)
A natural stone surface with a sandy texture that includes clefts which leave a layered appearance.



Limestone Texture (B)
A natural stone surface, similar to Veronica Stone but with a finer texture.



Heavy Stone Texture (D)
A rough, natural stone surface containing chips, fractures, pockmarks and veins.



Sanded Slate Texture (E)
Similar to our slate texture with the addition of a lightly sanded appearance across the entire texture field.



Renaissance Slate Texture (F)
A natural stone surface with a slight sandstone texture that includes various veins, typically running in a similar direction.

See page 15 for ordering information.



Chiseled Slate Texture (G)

A naturally laminated stone texture, split along parallel planes, hand-tooled to create a chipped, fragmented look.



Yucatan Texture (J)

A stone surface consisting of deep chips, pits and fractures creating a continuously undulating texture.



Roman Slate Texture (H)

A sanded slate stone surface that utilizes dips, ridges and veins to create a continuously changing texture across the entire surface.



Original Roman Slate Texture (I)

A smooth slate stone surface that utilizes dips, ridges and veins to create a continuously changing texture across the entire surface.



Sierra Seamless Texture (K)

A natural stone texture with an ocean-worn surface that combines rough, heavy, stone appearance with water-washed ridges, veins and clefts.





Texas Sea Shells (N)
Random pieces of sea shells and coral of various sizes, shapes and types laid in a random fashion over a field of sand.

See page 15 for ordering information.



Rocky Mountain Stone Texture (L)
A natural stone surface that incorporates a rough, uneven texture with naturally etched veins and ridges.



Veronica Stone (M)
The design is similar Bush Stone, and appears to be created by a mason's bush hammer with a pitted and irregular surface.



Smooth Slate Texture (O)
A naturally laminated stone texture, split along parallel planes, creating an uneven surface that incorporates various veins and ridges.



Desert Slate Texture (P)
A simulated slate texture that combines numerous clefts and irregular surfaces to create the ideal concrete impressions.

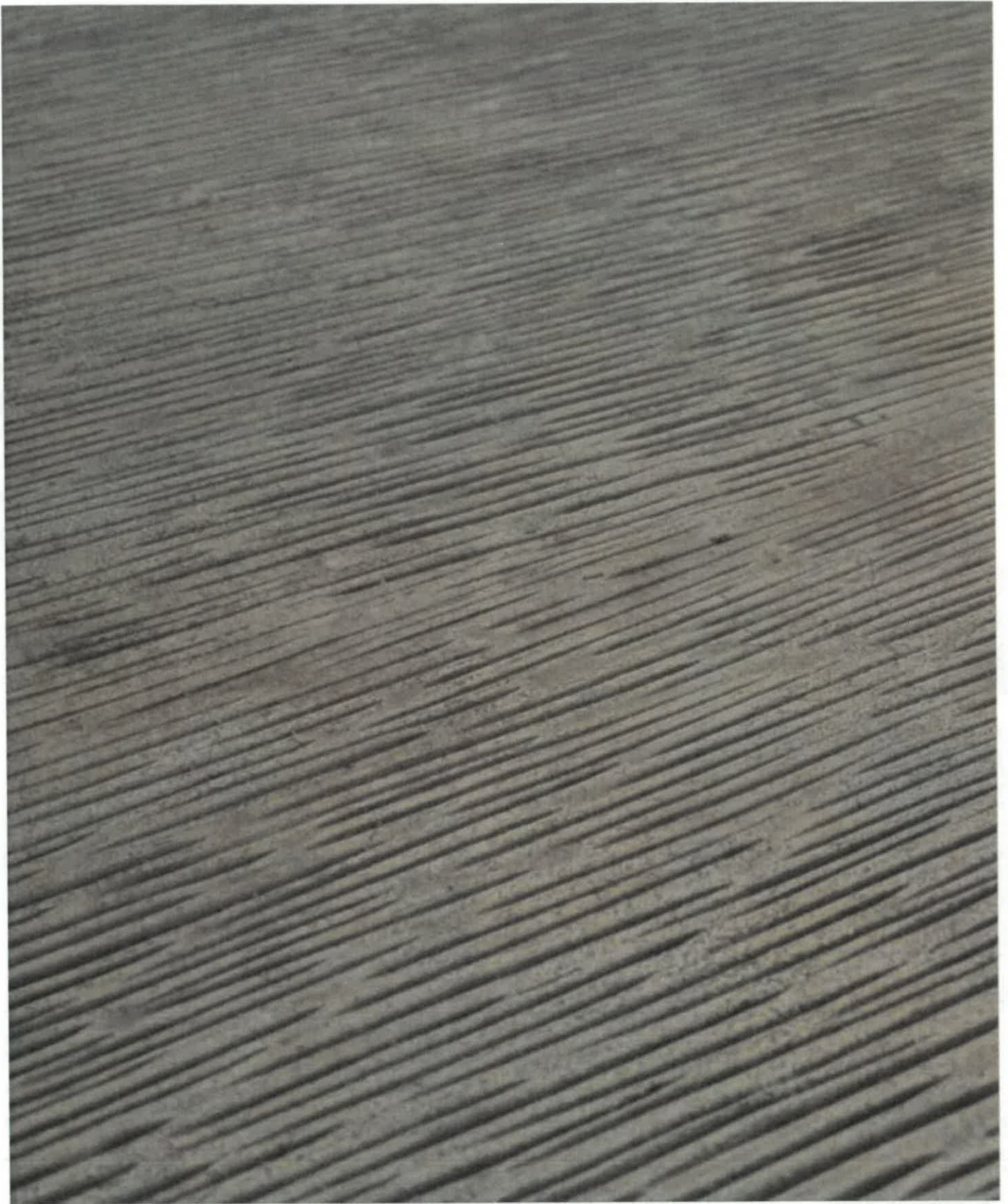

Casa Rubia (Y)

A unique hand-chiseled texture that yields a thatch-like appearance. Great for pool decks.

See page 15 for ordering information.



Elk Mountain Texture (Q)
A consistent light stone texture, making it appealing for indoor and outdoor applications.



Elk Mountain Texture (veined) (R)
A light stone texture with well-placed fractures, making it appealing for indoor and outdoor applications.



Regal Ashlar Slate (S)
A robust texture, with constantly changing ridges that bring a majestic and noble look to any surface.



Cracked Mud (T)
A bold, daring, natural earth texture with a surface that looks and feels real.



Lunar Rock (U)

An out-of-this-world look that will transform any hardscape. The surface boasts a meteor shower of texture with a variety of impacted stones.



Super Slate (V)

A blended slate pattern with enhanced highlights.



Sidewalk Stone (W)

A rustic blend of soft and strong textures, giving a traditional feel to any surface.



Riviera Texture (X)

A naturally laminated stone texture, split along parallel planes, creating an uneven surface that incorporates various veins and ridges.

Paladiano Texture Mats by Bob Harris

These speciality tools are cast from natural stones in historical regions with authentic textures and shapes that are pleasing to the eye from all angles. England, Italy, Bulgaria, Greece, Cyprus and France are the locations which inspired the "Wonders of the World" stamping tool line.



Part #	YORKSHIRE COBBLE	Size	Weight	# per set
PD-100	Full tools	59" x 23.5"	22 lbs	6
PD-105	Left	29.5" x 23.75"	11 lbs	2
PD-110	Single Stone	8.5" x 4.75"	1 lb	3
PD-115	Double Row Border	43.5" x 9.5"	9 lbs	1
PD-120	Soldier Course Border	41.5" x 8"	7 lbs	1
PD-125	2x2 skin	24" x 24"	4 lbs	1
PD-130	1x1 skin	12" x 12"	1 lb	1
PD-100F	Full Floppy	59" x 23.5"	16 lbs	1
FM-6570	Touch-up wheel			1
PD-100S	Full set YORKSHIRE COBBLE with Instructional DVD			17

Yorkshire Cobble

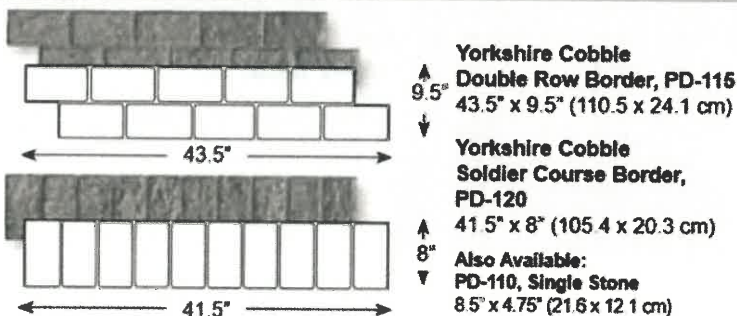
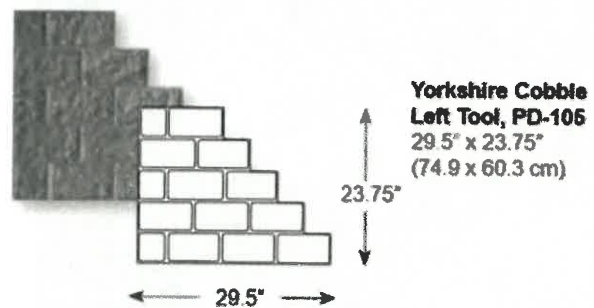
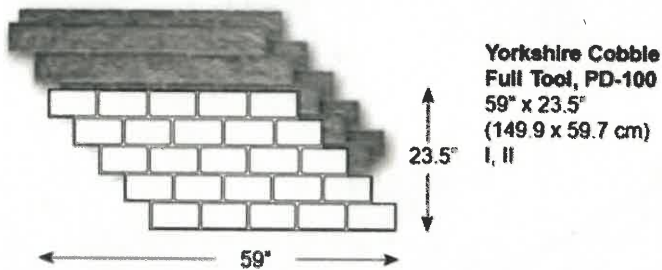

Fractured Cyprus Slate

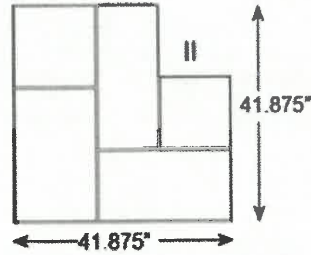
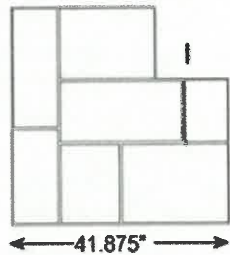
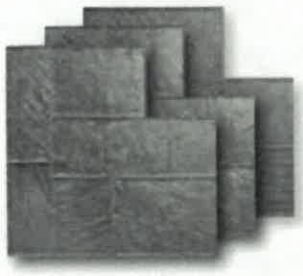

**Fractured Cyprus Slate
Full Tool, PD-600**
41.875" x 41.875"
(106.4 x 106.4 cm)
I, II, III, IV, V, VI, VII, VIII

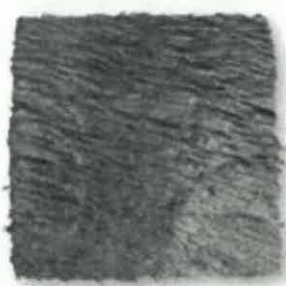
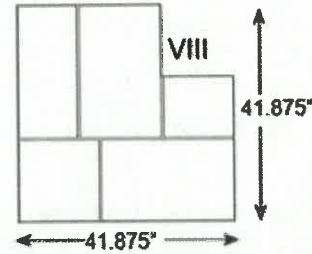
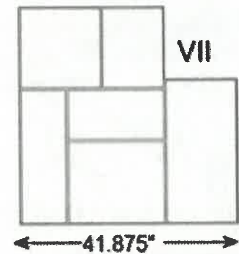
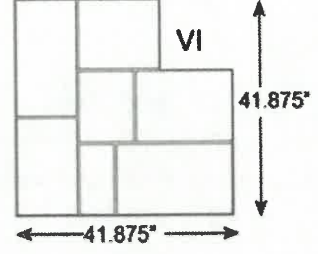
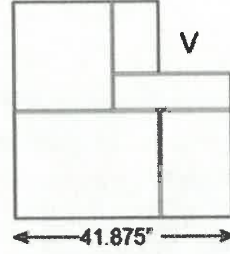
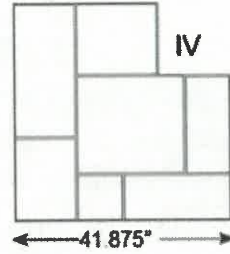
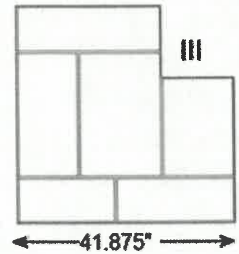

**Fractured Cyprus Slate
Small Skin, PD-605**
24" x 24"
(61 x 61 cm)

Also Available:
PD-610, Extra-Small Skin
12" x 12" (30.5 x 30.5 cm)



Part #	FRACTURED CYPRUS SLATE	Size	Weight	# per set
PD-600	Full tool	41.875" x 41.875"	33 lbs	8
PD-605	2x2 skin	24" x 24"	4 lbs	2
PD-610	1x1 skin	12" x 12"	1 lb	1
PD-600F	Full Floppy	41.875" x 41.875"	20 lbs	1
FM-6520	Touch-up wheel			1
PD-600S	Full set FRACTURED CYPRUS SLATE with Instructional DVD			13



Part #	STONES OF ATHENS	Size	Weight	# per set
PD-400	Full tool	47.75" x 23.875"	24 lbs	6
PD-405	2x2 skin	24" x 24"	4 lbs	3
PD-410	1x1 skin	12" x 12"	1 lb	1
PD-400F	Full Floppy	47.75" x 23.875"	17 lbs	2
FM-6570	Touch-up wheel			1
PD-400S	Full set STONES OF ATHENS with Instructional DVD			15

Stones of Athens

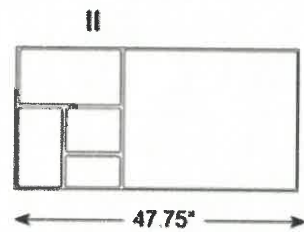
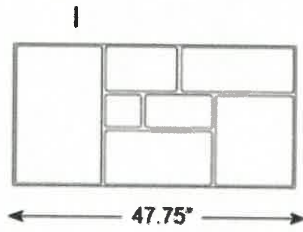

Stones of Athens Full Tool, PD-400
 47.75" x 23.875"
 (121.3 x 60.6 cm)
 I, II, III, IV, V, VI, VII, VIII

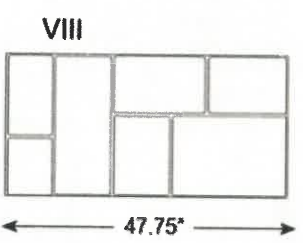
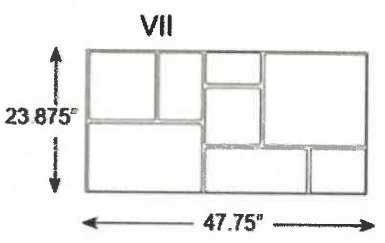
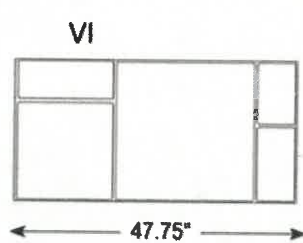
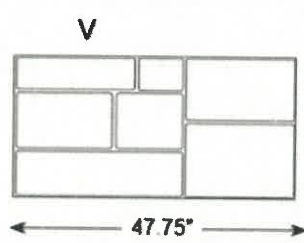
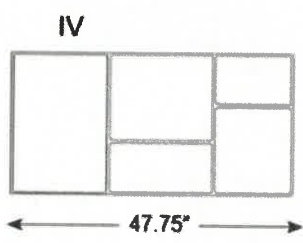
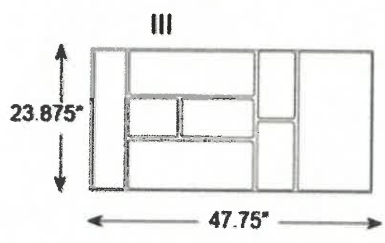

Stones of Athens Small Skin, PD-405
 24" x 24"
 (61 x 61 cm)

Also Available:
 PD-410, Extra-Small Skin
 12" x 12" (30.5 x 30.5 cm)

Rotating Venetian Marble

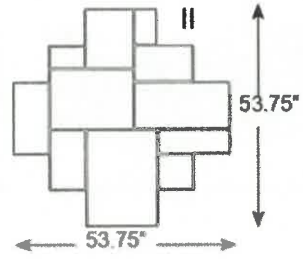
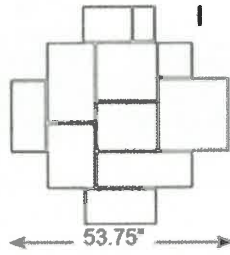
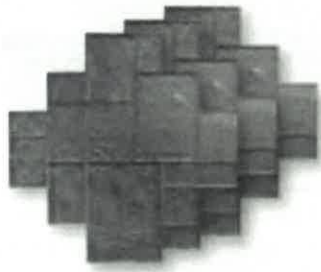

**Rotating Venetian Marble
Full Tool, PD-500**
53.75" x 53.75"
(136.5 x 136.5 cm)
I, II, III, IV, V, VI

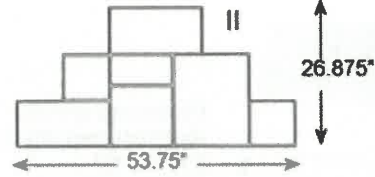
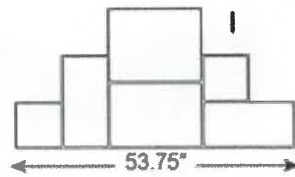
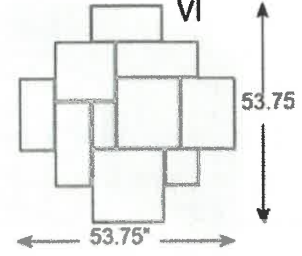
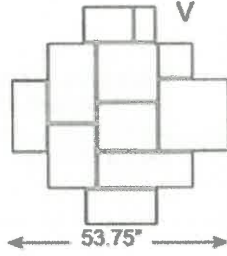
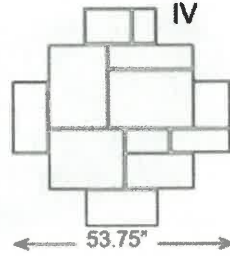
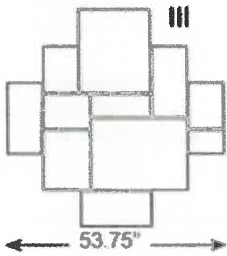

**Rotating Venetian Marble
Half Tool, PD-505**
53.75" x 26.875"
(106.4 x 68.3 cm)
I, II

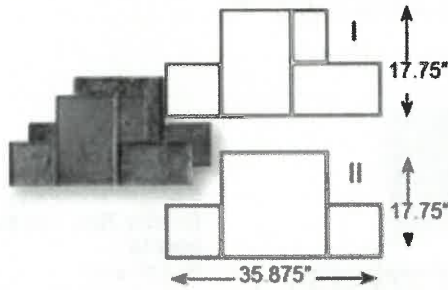

**Rotating Venetian Marble
Quarter Tool, PD-510**
35.875" x 17.75"
(91.1 x 45.1 cm)
I, II

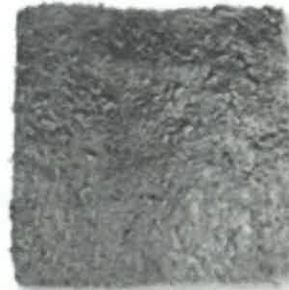

**Pavimento of Paris
Small Skin, PD-515**
24" x 24"
(61 x 61 cm)

Also Available:
PD-520, Extra-Small Skin
12" x 12" (30.5 x 30.5 cm)

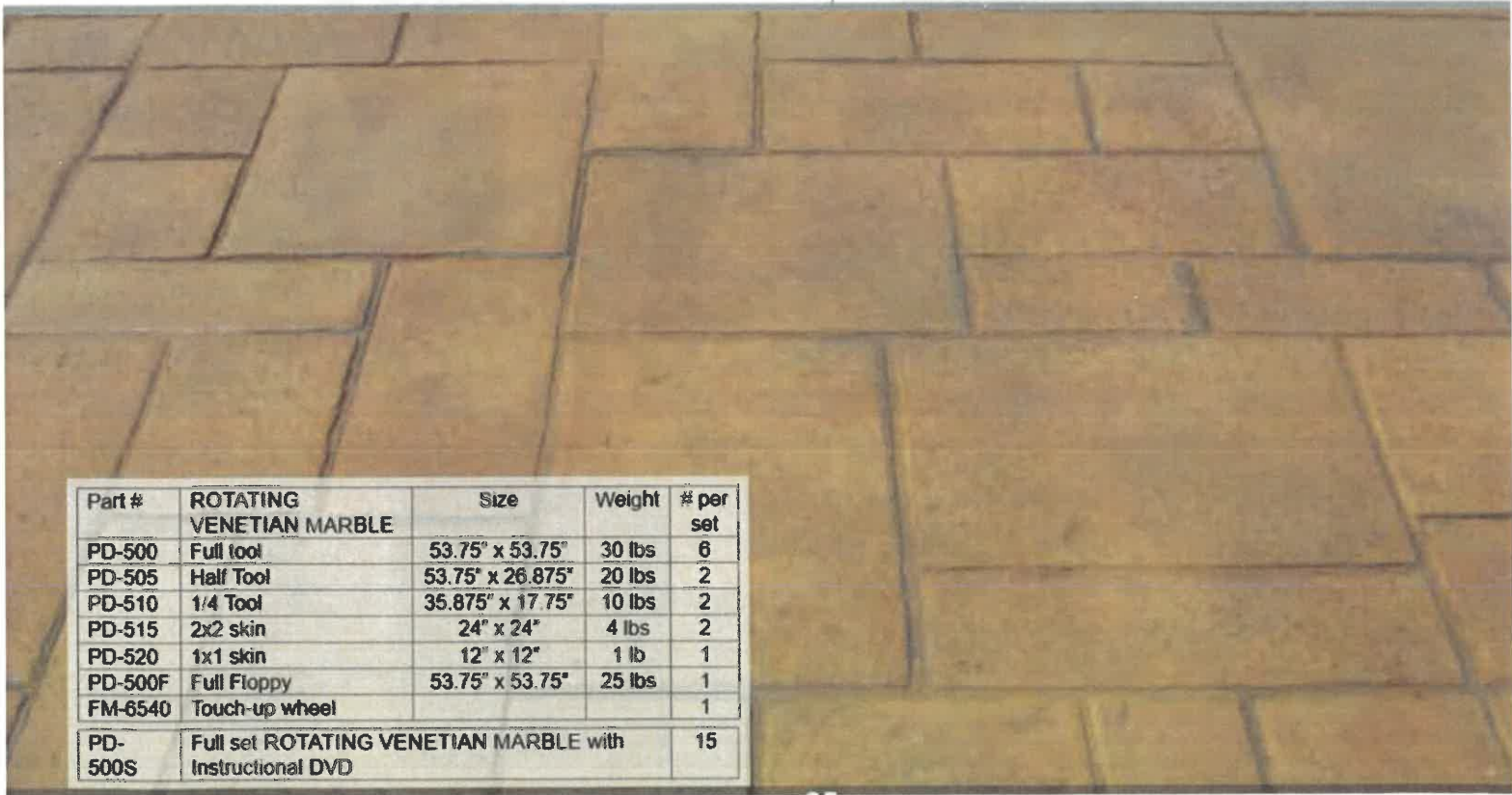

Part #	ROTATING VENETIAN MARBLE	Size	Weight	# per set
PD-500	Full tool	53.75" x 53.75"	30 lbs	6
PD-505	Half Tool	53.75" x 26.875"	20 lbs	2
PD-510	1/4 Tool	35.875" x 17.75"	10 lbs	2
PD-515	2x2 skin	24" x 24"	4 lbs	2
PD-520	1x1 skin	12" x 12"	1 lb	1
PD-500F	Full Floppy	53.75" x 53.75"	25 lbs	1
FM-6540	Touch-up wheel			1
PD-500S	Full set ROTATING VENETIAN MARBLE with Instructional DVD			15

Pavimento of Paris

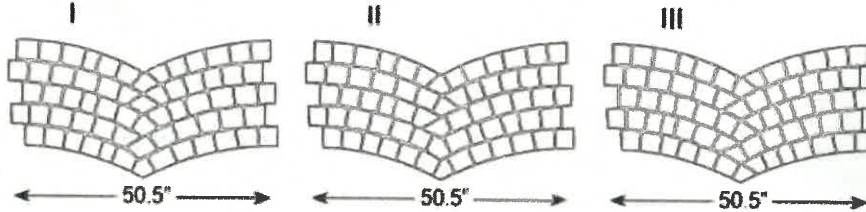

Pavimento of Paris
Full Tool, PD-200
50.5" x 25"
(128.3 x 63.5 cm)
I, II, III

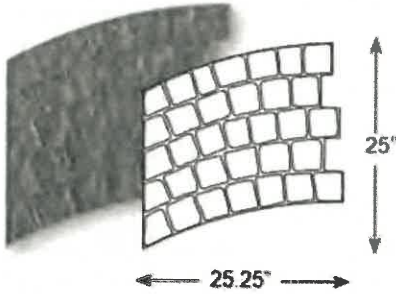

Pavimento of Paris
Half Tool, Left, PD-206
25.25" x 25"
(64.1 x 63.5 cm)

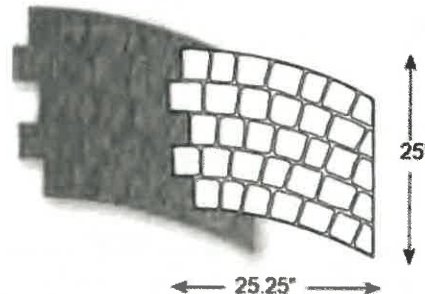

Pavimento of Paris
Half Tool, Right, PD-210
25.25" x 25"
(64.1 x 63.5 cm)

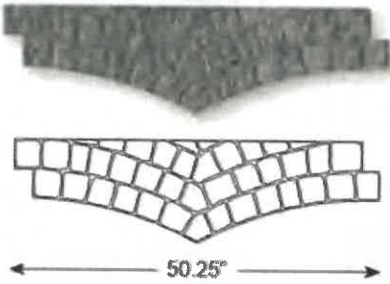

Pavimento of Paris
Half Tool, Top, PD-216
50.25" x 12"
(127.6 x 30.5 cm)

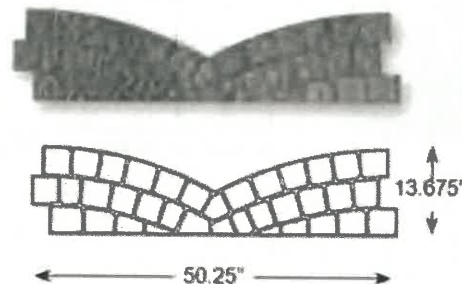

Pavimento of Paris
Half Tool, Bottom, PD-220
50.25" x 13.675"
(127.6 x 34.7 cm)

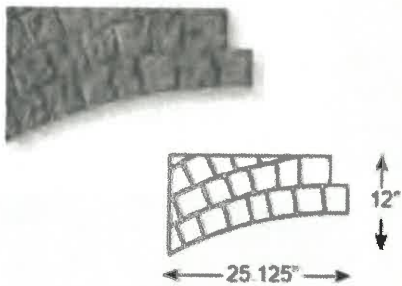

Pavimento of Paris
Quarter Tool, Top Left,
PD-217
25.125" x 12"
(63.8 x 30.5 cm)

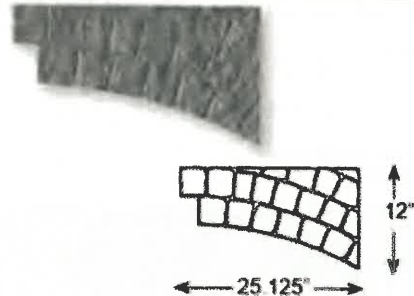

Pavimento of Paris
Quarter Tool, Top Right,
PD-216
25.125" x 12"

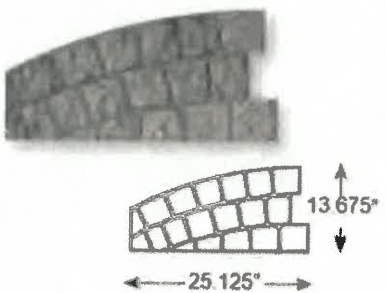

Pavimento of Paris
Quarter Tool, Bottom Left,
PD-222
25.125" x 13.675"
(63.8 x 34.7 cm)

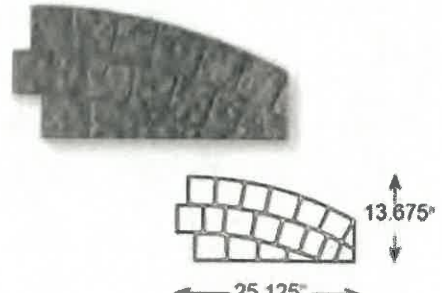

Pavimento of Paris
Quarter Tool, Bottom
Right, PD-221
25.125" x 13.675"
(63.8 x 34.7 cm)

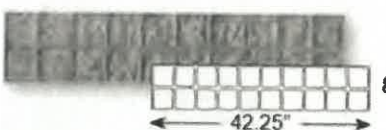

Pavimento of Paris
Stacked Bond, PD-230
42.25" x 8.5" (107.3 x 21.6 cm)



Pavimento of Paris
Granite Cobble, PD-235
43.5" x 6.25" (110.5 x 15.9 cm)

Also Available:
PD-226, Single Stone
3.875" x 3.675" (9.8 x 9.3 cm)



Pavimento of Paris
Small Skin, PD-240
24" x 24"
(61 x 61 cm)

Also Available:
PD-246, Extra-Small Skin
12" x 12" (30.5 x 30.5 cm)

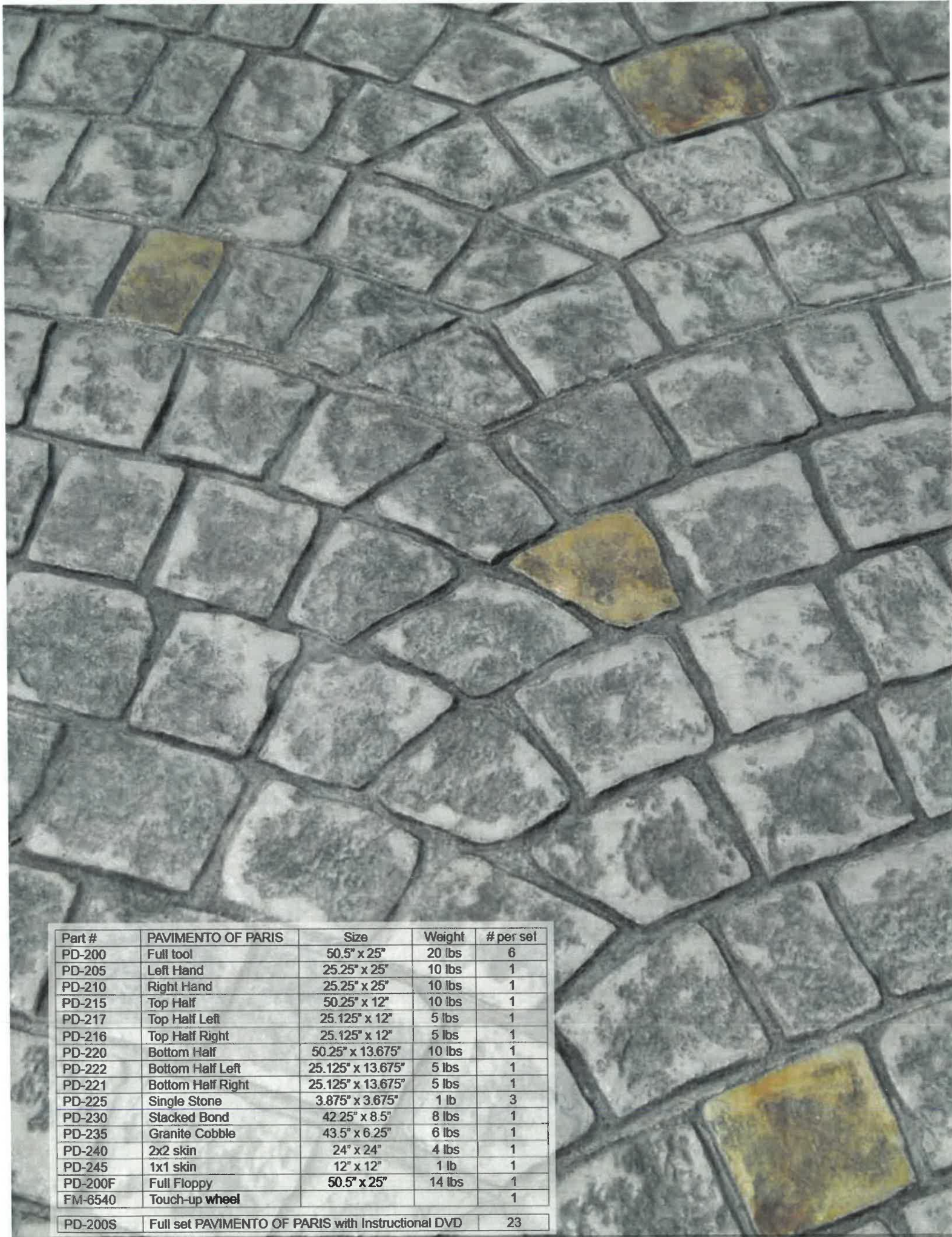

Part #	PAVIMENTO OF PARIS	Size	Weight	# per set
PD-200	Full tool	50.5" x 25"	20 lbs	6
PD-205	Left Hand	25.25" x 25"	10 lbs	1
PD-210	Right Hand	25.25" x 25"	10 lbs	1
PD-215	Top Half	50.25" x 12"	10 lbs	1
PD-217	Top Half Left	25.125" x 12"	5 lbs	1
PD-216	Top Half Right	25.125" x 12"	5 lbs	1
PD-220	Bottom Half	50.25" x 13.675"	10 lbs	1
PD-222	Bottom Half Left	25.125" x 13.675"	5 lbs	1
PD-221	Bottom Half Right	25.125" x 13.675"	5 lbs	1
PD-225	Single Stone	3.875" x 3.675"	1 lb	3
PD-230	Stacked Bond	42.25" x 8.5"	8 lbs	1
PD-235	Granite Cobble	43.5" x 6.25"	6 lbs	1
PD-240	2x2 skin	24" x 24"	4 lbs	1
PD-245	1x1 skin	12" x 12"	1 lb	1
PD-200F	Full Floppy	50.5" x 25"	14 lbs	1
FM-6540	Touch-up wheel			1
PD-200S	Full set PAVIMENTO OF PARIS with Instructional DVD			23

Hammered Sofia Stone

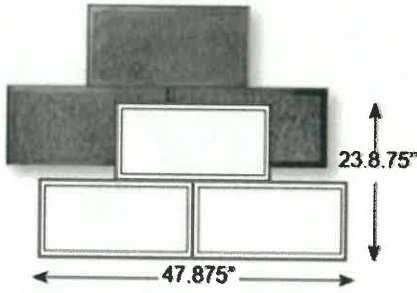

Hammered Sofia Stone Full Tool, PD-300
47.875" x 23.875"
(121.6 x 60.6 cm)

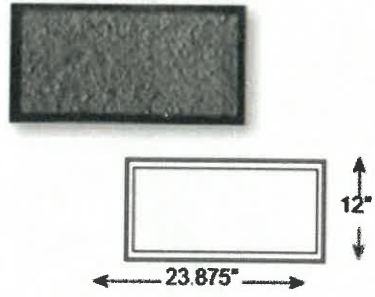

Hammered Sofia Stone Single Stone, PD-305
23.875" x 12"
(60.6 x 34.7 cm)

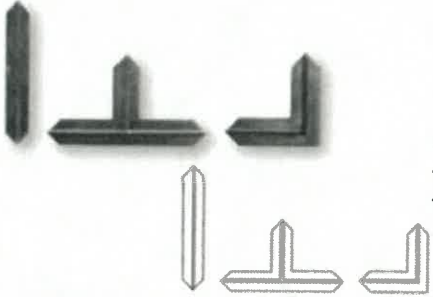

Hammered Sofia Stone Joint Tools, PD-310
Assorted sizes



Hammered Sofia Stone Small Skin, PD-315
24" x 24"
(61 x 61 cm)

Also Available:
PD-320, Extra-Small Skin
12" x 12" (30.5 x 30.5 cm)



Part #	HAMMERED SOFIA STONE	Size	Weight	# per set
PD-300	Full tool	47.875" x 23.875"	18 lbs	8
PD-305	Single Stone	23.875" x 12"	6 lbs	2
PD-310	Joint tools	assorted	1 lb	3
PD-315	2x2 skin	24" x 24"	2 lbs	1
PD-320	1x1 skin	12" x 12"	1 lb	1
PD-300F	Full Floppy	47.875" x 23.875"	12 lbs	1
PD-300S	Full set HAMMERED SOFIA STONE with Instructional DVD			16

Stone Texture Mats

Whether you want the look of granite, blue stone, old English cobblestone, Mexican tile, or pavers, Brickform offers an array of texture mats that simulate a broad range of natural stone materials. Achieving these beautiful results with Brickform precision tools is often more affordable and easier than it is with natural materials. Brickform has a stone texture tool ready to complement any design theme – from an Italian Villa to an English Country Garden.

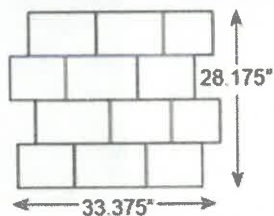

Large Cobble, FM-580

28.125" x 33.375" (71.43 x 84.77 cm) Blue
Larger rough-cut cobblestones
Matching skin/touch-up wheel Smooth Slate/TW-1
Joint width 1/4"-1/2", depth 3/8"
Stone size 6 1/2"-6 3/4" wide, 7 1/2"-11 1/4" long



Tuscany Stone, FM-1775

28" x 40" (71.12 x 101.60 cm)

Red, Yellow and Blue

A large tool with a stone texture and interlocking joints on all four sides

Matching skin/touch-up wheel: Rough Stone/TW-5

Joint 1/4" wide, 3/16" deep

Stone sizes vary from 3 1/8" x 7 3/4" to 3 1/8" x 9 1/4"

Also Available: Tuscany Border, FM-1785

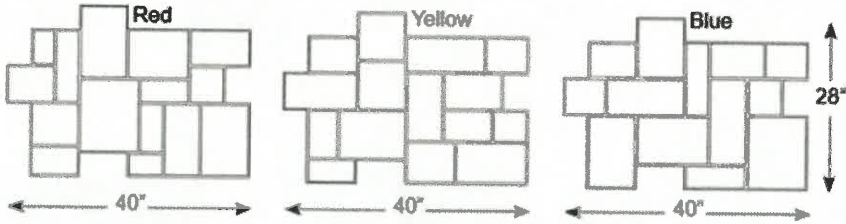

Rough Cut Ashlar, FM-100 S/O

24" x 24" (60.96 x 60.96 cm)

Red, Yellow and Blue

Rough hand-tooled stones arranged in an Ashlar pattern

Matching skin/touch-up wheel: Rough Stone/TW-2

Grout 1/4"-3/8" wide, 1/4" deep

Available as gang tool, see page 61 for details.

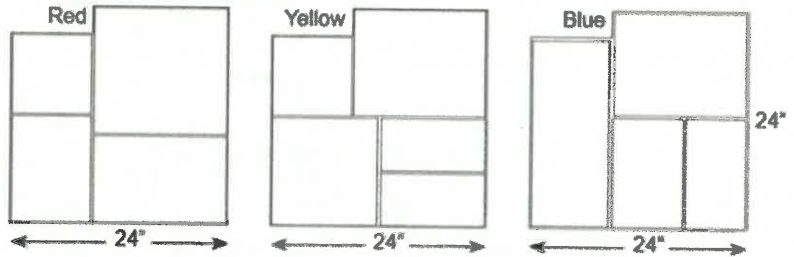

Australian Ashlar Cut Stone, FM-150 S/O

23.25" x 23.25" (59.05 x 59.05 cm)

Red, Yellow and Blue

A coarse rugged Blue Stone set in an Ashlar pattern

Matching touch-up wheel: TW-1

Grout 1/4"-3/4" wide

Grout 1/8" deep

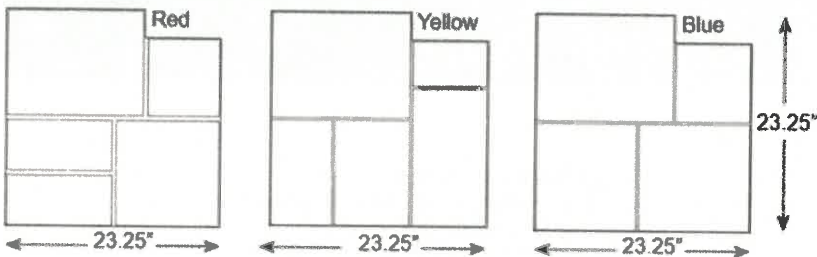

S/O - Compatible with Brickform Stampable Overlay

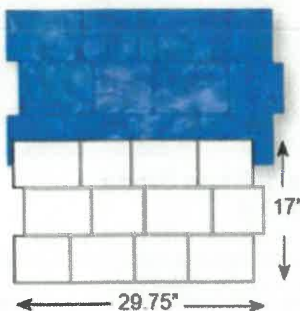

London Cobble, FM-540 S/O
 17" x 29.75" (43.18 x 75.56 cm) Blue
 A traditional lightly textured cobblestone pattern
 Matching skin/touch-up wheel. Slate/TW-1
 Joint 1/8"-1/4" wide, 1/4" deep
 Stone size 5 1/2"-5 3/4" wide, 6"-8" long

Available as gang tool, see page 59 for details.
 Available as Contractors Choice, EF-540. 

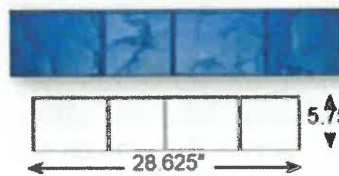

London Cobble Strip, FM-560 S/O
 5.75" x 28.625"
 (14.605 x 72.71 cm) Blue
 Matching skin/touch-up wheel. Slate/TW-1
 Joint 1/8"-1/4" wide, 1/4" deep
 Stone size 5 1/2"-5 3/4" wide, 5 1/4"-8" long

A lightly textured cobblestone pattern in a single strip

S/O - Compatible with Brickform Stampable Overlay

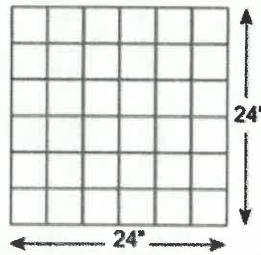
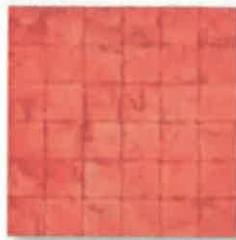

4" x 4" Slate Sets, FM-200 S/O
 24" x 24" (60.96 x 60.96 cm) Red
 Slate texture with a hand-chiseled edge
 Matching skin/touch-up wheel: Smooth Slate/TW-1
 Joint size 1/8"-1/4" wide
 Stone size 4"

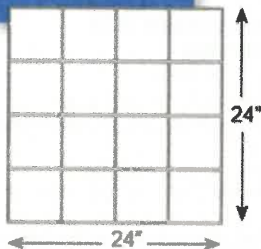

6" x 6" Granite Sets, FM-250 S/O
 24" x 24" (60.96 x 60.96 cm) Blue
 Rough Stone texture with a hand-chiseled edge
 Matching skin/touch-up wheel: Rough Stone/TW-1
 Joint size 3/8"-1/2" wide, 1/4" deep
 Stone size 5 3/4"

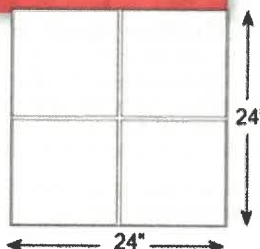
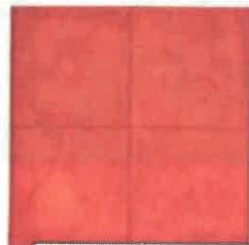

12" x 12" Cut Stone, FM-300 S/O
 24" x 24" (60.96 x 60.96 cm) Red
 A rough natural stone, hand-tooled to create a chipped and fragmented texture
 Matching skin/touch-up wheel: Smooth Slate/TW-1
 Joint size 1/4"-3/4" wide, 3/8" deep
 Stone size 12"

S/O - Compatible with Brickform Stampable Overlay



Windsor Cobble, FM-500 S/O
 22.75" x 29.75" (57.78 x 75.56 cm) Blue

A traditional cobblestone pattern with wider joints.

Matching skin/touch-up wheel: Smooth Slate/TW-2
 Joint size 1/8"-3/8" wide, 1/8" deep
 Stone size 5 1/4"-5 1/2" wide, 6"-7 1/4" long

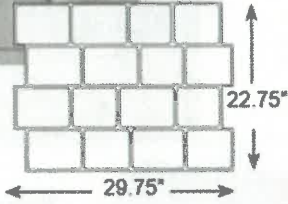

6" x 6" Edinburgh Cobble, FM-520

26" x 36" (66.04 x 91.44 cm) Yellow

A rugged weathered cobblestone pattern

Matching touch-up wheel: TW-7
 Joint size 1/2"-3/4" wide, 1/2" deep
 Stone size 5 3/4"-6" wide, 5 7/8"-6 1/4" long
 Available as Contractors Choice, EF-520

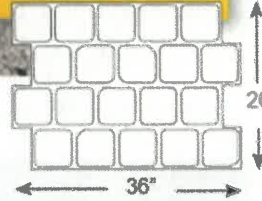

Cheshire Cobble

(Smooth Grout), FM-525

20.5" x 46" (52.07 x 116.84 cm) Red

A traditional cobblestone pattern with smooth, ungrouted joints

Matching touch-up wheel: TW-1

Joint size 1/4"-3/4" wide, 3/8" deep

Stone size 4 3/4"-4 1/4" wide, 5 1/4"-9 1/4" long

HINT! Matching thin mats "flopies" are available for all Brickform Texture Mats

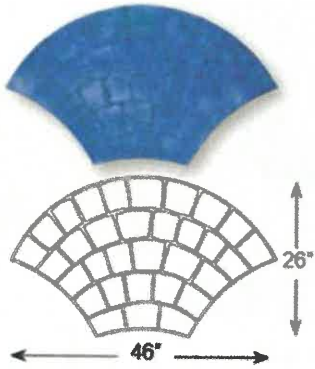

European Fan, FM-650 s/O
 26" x 46" (66.04 x 116.84 cm) Blue
 An elegant European fan pattern, consisting of slightly curved rectangular slate stones
 Matching skin/touch-up wheel: Smooth Slate/TW-2
 Joint size 1/4"-1/2" wide, 3/8" deep
 Stone size 3 3/4"-5 1/2" wide, 4"-6 1/2" long

Available as Contractors Choice, EF-650 

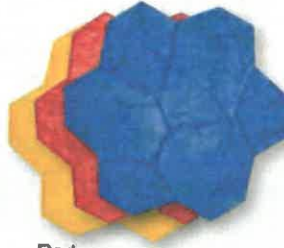

Random Stone, FM-700
 29.125" x 29.125" (73.97 x 73.97 cm) Red, Yellow and Blue. Heavily textured random fieldstones
 Matching skin/touch-up wheel: Rough Stone/TW-2
 Joint size 1/4"-3/4" wide, 3/8" deep
 Stone size 7"-11 1/2" wide, 10"-15" long

Available as Contractors Choice, EF-700 

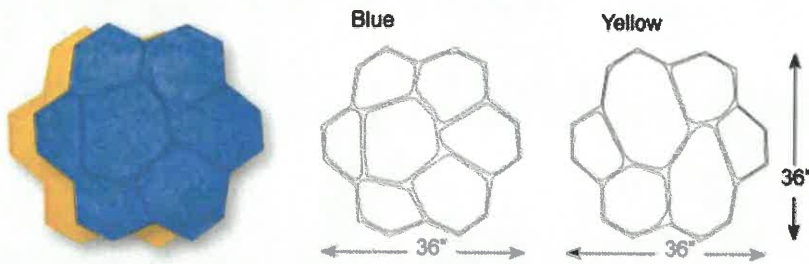
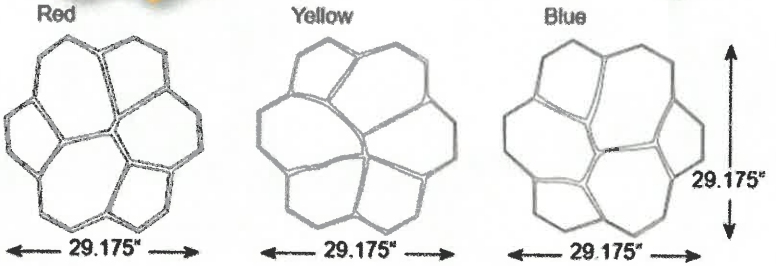

Large Random Stone, FM-750
 36" x 36" (91.44 x 91.44 cm) Yellow and Blue
 Similar to Random Stone but 40% larger
 Matching skin/touch-up wheel: Rough Stone/TW-7
 Joint size 1/2"-1" wide, 3/8" deep
 Stone size 7"-14" wide, 13"-20 1/2" long



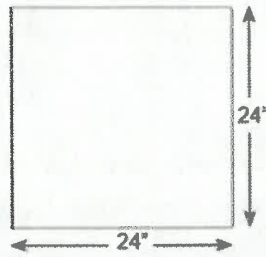

24" x 24" Yucatan Stone, FM-1100 S/O

24" x 24" (60.96 x 60.96 cm) Blue
A single square of rough Yucatan stone texture
Matching skin/touch-up wheel: Yucatan/TW-5
Surrounding joint size 1/4" wide, 1/4" deep



4" x 8" Cut Stone Border, FM-1225
8.375" x 33.5" (21.27 x 85.09 cm) Red
A border of slate rectangles laid side-by-side
Matching skin/touch-up wheel: Smooth Slate/TW-3
Joint size 1/4" wide, 1/4" deep
Stone size 4" wide, 8" long

Also Available: Cut Stone Single Brick
FM-1284, 4" x 8"

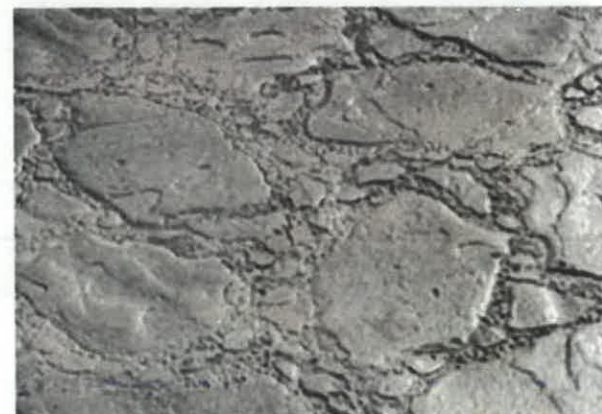
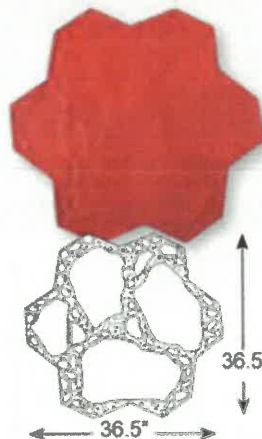

Patio Stone, FM-1295 S/O

36.5" x 36.5" (92.71 x 92.71 cm) Red
A roughly textured arrangement of random stones
Joint size 1/2"-2 1/2" wide

HINT! Matching thin mats "flopies" are available for all Brickform Texture Mats

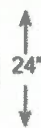
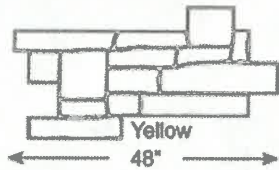
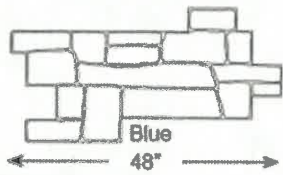
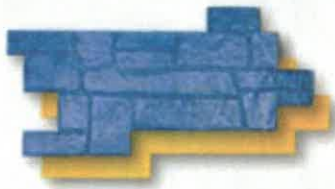

Roman Cobble, FM-1465

48" x 24" (121.9 x 61cm)

Blue and Yellow

A historic reproduction of cobbles that have a variety of stone shapes for old world appeal.

Matching skin/touch-up wheel:

Rough Stone/TW-6

Joint size 1/8"-1/2" wide, 1/8"-3/8" deep

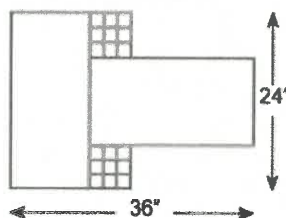

**Basket Weave
New Stone**

Weave Look, FM-460

36" x 24" (91.44 x 61cm) Blue

Matching skin: Regal Ashlar Slate

S/O - Compatible with Brickform Stampable Overlay

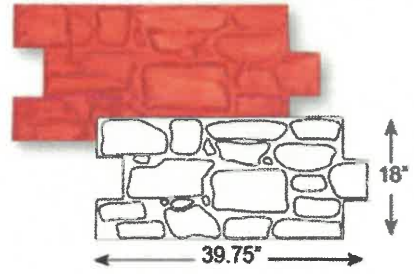

English Field Stone, FM-1350

18" x 39.75" (45.72 x 100.965 cm) Red

A natural arrangement of river rock, emulating the look of smooth English fieldstones

Matching touch-up wheel: TW-6

Joint size 1/4"-1" wide, 1/2" deep

Stone size 1'-6" wide, 1'-11 1/4" long

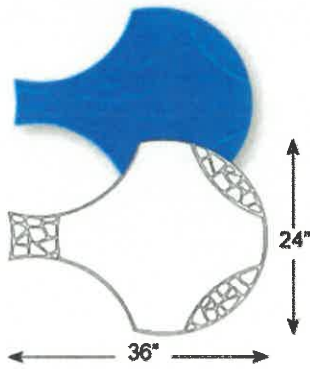

Circulos Del Sol,

FM-640

24" x 36" (60.96 x 116.84 cm)

Blue

Matching skin: Regal Ashlar Slate

Also Available:

FM-640LR, Left/Right

FM-640TB, Top/Bottom



Lincoln Trail Large Random, FM-760

65" x 36" (165.1 x 91cm)

Blue

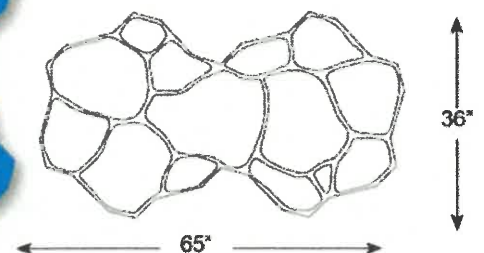

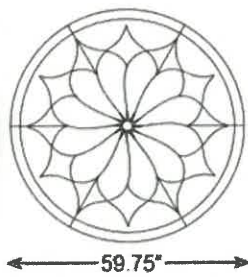

59.75"

59.75"

Lotus Blossom Medallion, FM-2492
60" x 60" (152.4 x 152.4 cm) Yellow
Joint size 3/8" wide, 3/8"-1/2" deep

Slate Texture Mats

Slate is a sleek, metamorphic rock with fine veining patterns. The grain pattern of slate makes it a common resource for tile flooring because it is easily split into thin sheets. Brickform slate texture tools recreate the elegant, clean design of slate without the expense and hassle of installing fragile natural stones. Brickform Ashlar texture mats reflect the handcrafted, intricately-fitting stones of historic Ashlar configurations.



36" Ashlar Cut Slate, FM-3120 S/O

36" x 36" (91.44 x 91.44 cm)

Red, Yellow and Blue

Stones with a slate surface in an Ashlar pattern

Matching skin/touch-up wheel.

Smooth Slate/TW-5

Joint size 1/4"-1/2" wide, 1/4" deep

Available as Contractors Choice, EF-3120

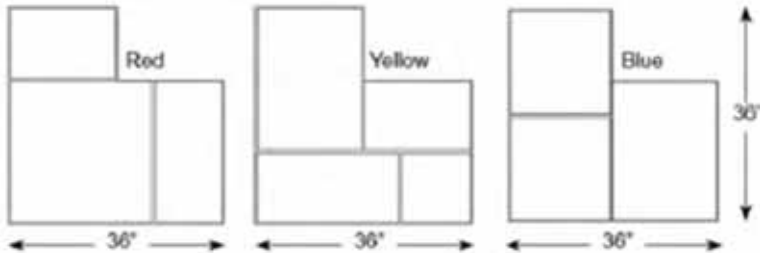

Ashlar Cut Slate, FM-3125 S/O

23.125" x 23.125" (58.74 x 58.74 cm)

Red, Yellow and Blue

A naturally laminated stone texture split along parallel

planes, hand-tooled to create a more pronounced,

chipped, fragmented texture with small, deep joints

Matching skin/touch-up wheel Smooth Slate/TW-1

Joint size 1/4"-1/2" wide, 1/4" deep

Stone size 5 1/4"-9 1/4" wide, 6 1/4"-20 1/4" long

Available as Contractors Choice, EF-3125



* Available as gang tool, see page 61 for details.

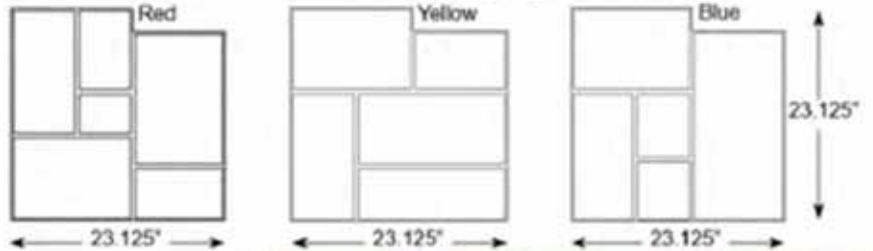

Aidan Ashlar, FM-3130 S/O

23.125" x 23.125" (58.74 x 58.74 cm)

Red, Yellow and Blue

Similar to the Ashlar Cut Slate but with broad shallow joints

Matching skin/touch-up wheel: Smooth Slate/TW-5

Joint size 1/4"-3/4" wide, 1/2" deep

Stone size 5 1/4"-9 1/4" wide, 6 1/4"-20 1/4" long

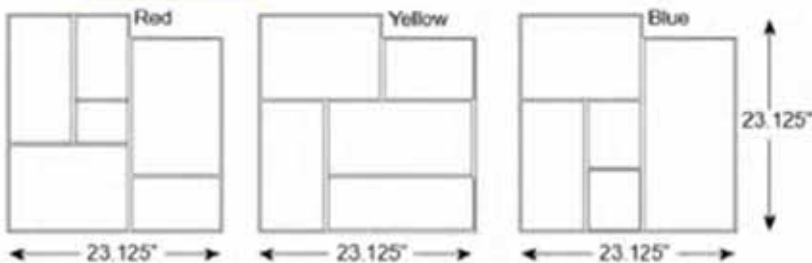

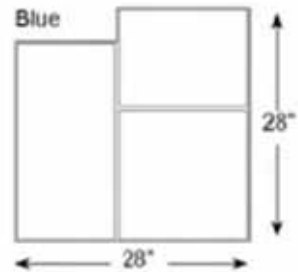
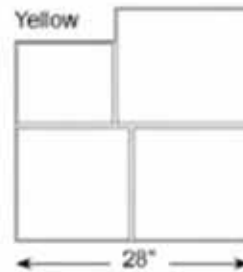
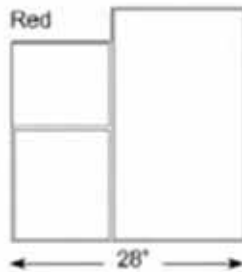

Large Ashlar Cut Slate
FM-3150 S/O
 28" x 28" (71.12 x 71.12 cm)
 Red, Yellow and Blue

Similar to Ashlar Cut Slate but the overall size is larger, with a softer texture
 Matching skin/touch-up wheel: Smooth Slate/TW-5
 Joint size 1/4"-1/4" wide, 1/2" deep
 Stone size 10"-16" wide, 12"-26" long

Available as Contractors Choice, EF-3150

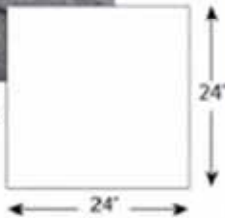
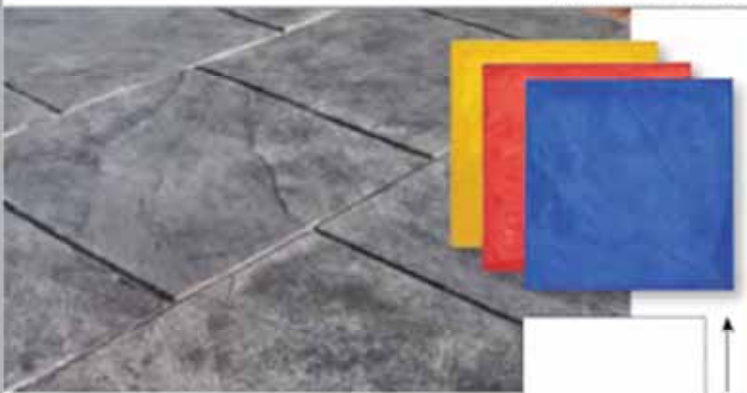

24" x 24" Slate Texture, FM-3200 S/O
 24" x 24" (60.96 x 60.96 cm)
 Red, Yellow and Blue
 One complete stone with hand-tooled slate texture
 Matching skin/touch-up wheel: Smooth Slate/TW-5

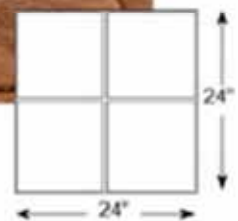

12" x 12" Slate, FM-3250 S/O
 24" x 24" (60.96 x 60.96 cm) Blue
 Slate tiles laid in a parallel pattern
 Matching skin/touch-up wheel: Smooth Slate/TW-5
 Joint size 1/4"-1/2" wide, 1/2" deep
 Stone size 12" square



12" x 12" Slate Border
FM-3300 S/O
 12" x 48" (30.48 x 121.92 cm) Red
 A border of four 12" slate squares in a row
 Matching skin/touch-up wheel: Smooth Slate/TW-5
 Joint size 1/4" wide, 1/2" deep

S/O - Compatible with Brickform Stampable Overlay

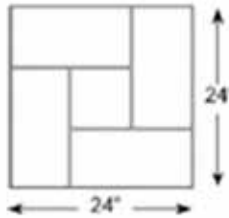

California Weave, FM-3500 S/O
 24" x 24" (60.96 x 60.96 cm) Red
 Slate bricks form a woven pattern around a slate square.
 Matching skin/touch-up wheel. Smooth Slate/TW-5
 Joint size 1/2"-1/4" wide, 1/8" deep
 Stone sizes 8"x8" and 6"x16"

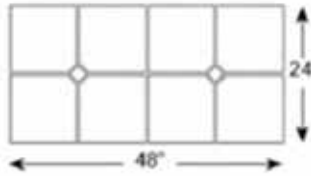

Slate with Diamond Inset
FM-3350 S/O
 24" x 48" (60.96 x 121.92 cm) Blue
 An elegant arrangement of Italian slate, with diamond-shaped insets for added detail
 Matching skin/touch-up wheel. Smooth Slate/TW-5
 Joint size 1/8" wide, 1/8" deep
 Stone size 12" square, diamond inset size 4" square



Walkway Slate, FM-3400 S/O

18" x 36" (45.72 x 91.44 cm)

*Red, Yellow and Blue

*Stone sizes vary

Square and rectangular slate tiles, of various sizes, set in parallel rows.

Matching skin/touch-up wheel: Smooth Slate/TW-5

Joint size 1/2"-5/8" wide, 1/2" deep

Stone size 18" wide, 12"-24" long

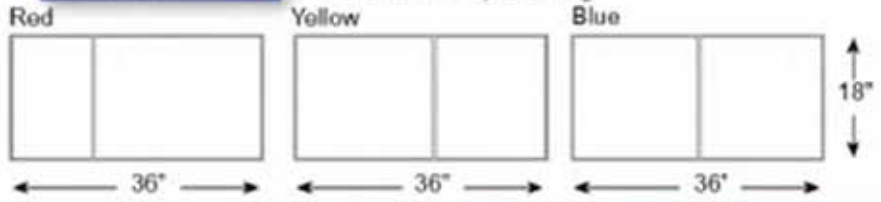

Grand Ashlar, FM-3675

36" x 36" (91.44 x 91.44 cm)

Red, Yellow and Blue

Stones of various shapes and sizes laid in an Ashlar pattern, with a slate texture

Matching touch-up wheel: TW-5

Joint size 1/4"-1/2" wide, 1/4" deep

Stone size 6"-15" wide, 6"-22" long

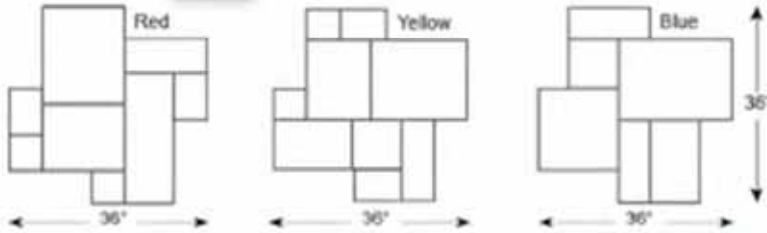

New England Basket Weave FM-3600 S/O

24" x 36" (60.96 x 91.44 cm) Blue

Hand-tooled slate in a basket weave pattern

Matching skin/touch-up wheel: Smooth Slate/TW-5

Joint size 1/2"-5/8" wide, 1/2" deep

Stone size 6" wide, 12" long

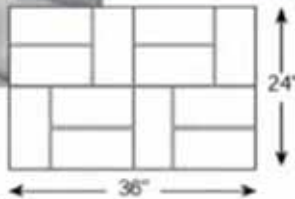

Herringbone Slate, FM-3550 S/O

32" x 40" (81.28 x 101.6 cm) Blue

A classic herringbone pattern of slate stones

laid at right angles to each other

Matching skin/touch-up wheel: Smooth Slate/TW-5

Joint size 1/2"-5/8" wide, 1/2" deep

Stone size 8" wide, 16" long

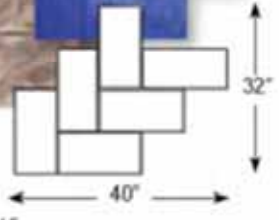

American Ashlar Slate, FM-3160

48" x 30" (121.9 x 61cm)

Red and Blue

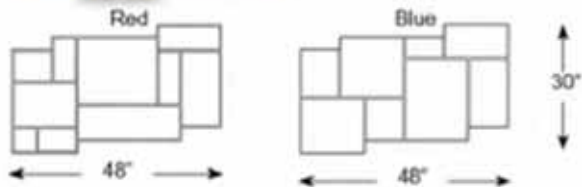

S/O - Compatible with Brickform Stampable Overlay

Slate Texture Mats *Made-to-Order* *2-week production lead time*

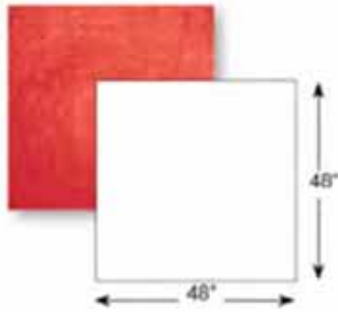

48" x 48" Slate Texture w/joint,
FM-3190 S/O
 48" x 48"
 (121.92 x 121.92 cm) Red
 A large single stone with slate texture
 and sharp cut corners and quarter
 inch surrounding joint
 Matching skintouch-up wheel:
 Smooth Slate/TW-5
 Surrounding joint 1/4" wide, 1/4" deep

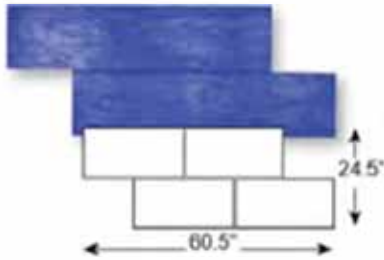

Running Bond Slate,
FM-3575
 24.5" x 60.5"
 (62.23 x 153.67 cm) Blue
 Renaissance slate texture set in a
 running bond pattern
 Matching skintouch-up wheel: Slate/
 TW-3
 Joint size 1/2" wide, 1/4" deep
 Stone size 11 1/2" wide, 23 1/2" long

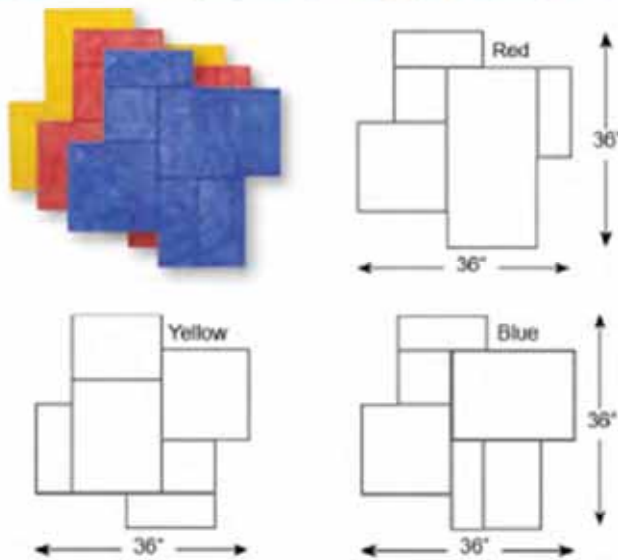

Regal Ashlar (Blue Stone), FM-3650 S/O
 36" x 36" (91.44 x 91.44 cm) Red, Yellow, and Blue
 Blue stone textured tiles, with worn beveled edges, arranged in an ashlar pattern
 Touch-up wheel: TW-5
 Joint size 1/2" wide, 1/4" deep. Stone size 6"-15" wide, 9"-30" long

Brick Texture Mats

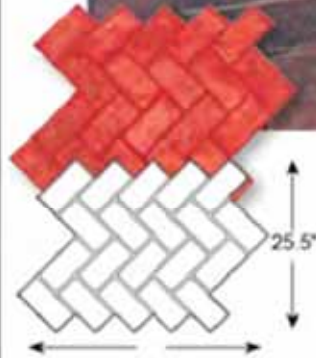

Herringbone Used Brick
FM-5000 S/O
 25.5" x 36.5" (64.77 x 92.71 cm) Red
 A weatherworn brick surface with an uneven
 texture and rounded broken edges
 Matching skintouch-up wheel: Used Brick/TW-4
 Joint size 1/2"-1/2" wide, 1/4" deep
 Brick size 3 1/2" wide, 7 1/2" long
 Available as gang tool, see page 59 for details.
 Available as Contractors Choice, EF-5000

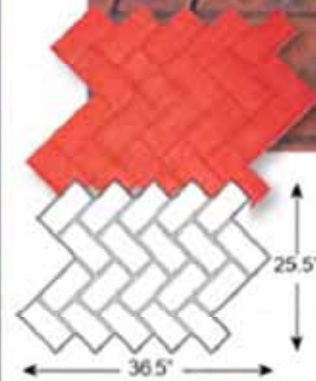

Herringbone New Brick
(Fine Grout), FM-5050 S/O
 25.5" x 36.5" (64.77 x 92.71 cm) Red
 A wire-cut common brick texture with sharp
 corners and few indentations or irregularities
 over the surface
 Matching skintouch-up wheel: New Brick/TW-4
 Joint size 1/2"-1/2" wide, 1/4" deep
 Brick size 3 1/2" wide, 7 1/2" long

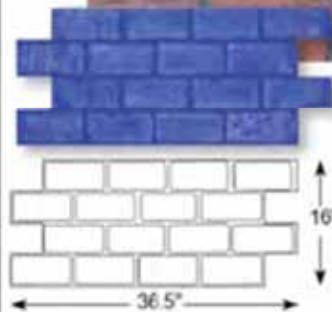

Running Bond Used Brick
FM-5100 S/O
 16" x 36.5" (40.64 x 92.71 cm) Blue
 Used bricks laid end-to-end, with sandy joints
 Matching skintouch-up wheel: Used Brick/TW-4
 Joint size 1/2"-1/2" wide, 1/4" deep
 Brick size 3 1/2" wide, 7 1/2" long
 Available as Contractors Choice, EF-5100
 Available as gang tool, see page 61 for details.

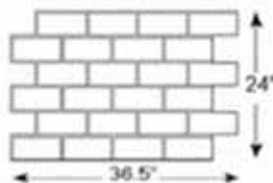

Running Bond New Brick
FM-5150 S/O

24" x 36.5" (60.96 x 92.71 cm) Red
A running bond pattern with smooth joints
Matching skin/touch-up wheel: New Brick/TW-4
Joint size 1/2"-1/2" wide, 1/4" deep
Brick size 3 1/2" wide, 7 1/2" long

Available as Contractors Choice, EF 5150

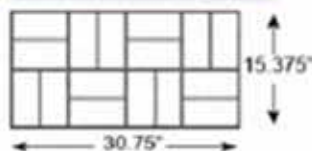

Basket Weave Used Brick
FM-5200 S/O

15.375" x 30.75" (39.05 x 78.10 cm) Blue
Used bricks in a basket weave pattern with smooth ungrouted joints
Matching skin/touch-up wheel: Used Brick/TW-4
Joint size 1/2"-1/2" wide, 1/4" deep
Brick size 3 1/2" wide, 7 1/2" long

Available as gang tool, see page 61 for details.

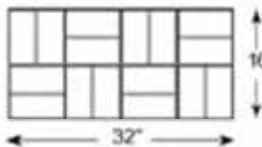

Basket Weave New Brick
FM-5250 S/O

16" x 32" (40.64 x 81.28 cm) Blue
New bricks in a basket weave pattern with sandy joints
Matching skin/touch-up wheel: New Brick/TW-4
Joint size 1/2"-1/2" wide, 1/4" deep
Brick size 3 1/2" wide, 7 1/2" long



Herringbone New Brick
(Sanded Joint) FM-5900 S/O

25.25" x 36.5" (64.12 x 92.71 cm) Red
New bricks with sandy joints
Matching skin/touch-up wheel: New Brick/TW-4
Joint size 1/2"-1/2" wide, 1/4" deep
Brick size 3 1/2" wide, 7 1/2" long



4" x 8" New Brick Border,
FM-5325, S/O

8.5" x 32.25" (21.59 x 81.92 cm) Red
A border of new bricks laid side-by-side
Matching skin/touch-up wheel: New Brick/TW-7

Also Available: 4" x 8" Used Brick Border, FM-5300 S/O

8.5" x 32" (21.59 x 81.28 cm) Red
A border of used bricks laid side-by-side
Matching skin/touch-up wheel: Used Brick/TW-4
Joint size 1/2"-1/2" wide, 1/4" deep
Brick size 3 1/2" wide, 7 1/2" long

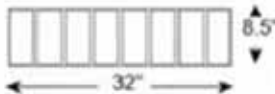

Single New Brick, FM-5550 S/O

4" x 8" (10.16 x 20.32 cm) Red
A single new brick with sharp edges
Joint size 1/2" wide, 1/4" deep
Brick size 3 1/2" wide, 7 1/2" long

Also Available:
Single Used Brick, FM-5500 S/O
4" x 8" (10.16 x 20.32 cm) Blue
A single used brick with rounded edges

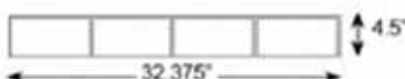

Used Brick Runner, FM-5600 S/O

4.5" x 32.375" (11.43 x 82.23 cm) Blue
A border of used bricks laid end-to-end
Joint size 1/2" wide, 1/4" deep
Brick size 3 1/2" wide, 7 1/2" long

HINT! Matching thin mats "flopies" are available for all Brickform Texture Mats

Wood Texture Mats

Made-to-Order 
2-week production lead time



Classic Wood FM-8700 S/O

81.5" x 21.75" (207 x 55.2 cm) Blue
Combining multiple wood grains to offer a bold, pronounced, exposed grain texture with six-inch wide planks
Matching skin/touch-up wheel: FM-8700FE/TW-5
Joint size 1/8" wide, 3/16" deep
Plank size 6" wide, 23 1/2"-71" long



Classic Wood with Nail Studs FM-8710 S/O

81.5" x 21.75" (207 x 55.2 cm) Red
Combining multiple wood grains to offer a bold, pronounced, exposed grain texture with six-inch wide planks and oversized nail heads
Matching skin/touch-up wheel: FM-8700FE/TW-5
Joint size 1/8" wide, 3/16" deep
Plank size 6" wide, 23 1/2"-71" long



- 2" Cedar Wood Plank, FM-8110 S/O
11.5" x 24" (29.21 x 60.96 cm) Blue
- 3" Cedar Wood Plank, FM-8210 S/O
11.5" x 36" (29.21 x 91.44 cm) Blue
- 4" Cedar Wood Plank, FM-8310 S/O
11.5" x 48" (29.21 x 121.92 cm) Blue
- 6" Cedar Wood Plank, FM-8410 S/O
11.5" x 72" (29.21 x 182.88 cm) Blue
- 8" Cedar Wood Plank, FM-8510 S/O
11.5" x 96" (29.21 x 243.84 cm) Blue

A cedar wood texture with coarse, pronounced grain and a rough surface appearance that incorporates oversized nail heads at each end

Matching skin/touch-up wheel: FM-8010FE/TW-5
Surrounding joint 1/8"



- 2" Wood Plank, FM-8100 S/O 
12" x 24" (30.48 x 60.96 cm) Blue
- 3" Wood Plank, FM-8200 S/O
12" x 36" (30.48 x 91.44 cm) Blue
- 4" Wood Plank, FM-8300 S/O
12" x 48" (30.48 x 121.92 cm) Blue
- 6" Wood Plank, FM-8400 S/O
12" x 72" (30.48 x 182.88 cm) Blue
- 8" Wood Plank, FM-8500 S/O
12" x 96" (30.48 x 243.84 cm) Blue

A wood grain texture with lightly pronounced veins and a mild surface texture

Matching skin/touch-up wheel: FM-8000FE/TW-5
Surrounding joint 1/8"

S/O - Compatible with Brickform Stampable Overlay



Classic Wood



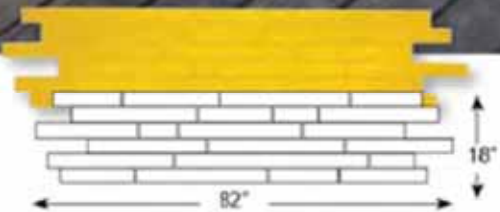

3" Cedar Wood Flooring, FM-8015
 18" x 82" (45.72 x 208.28 cm) Yellow
 Cedar wood planks laid end-to-end
 Matching skin/touch-up wheel: FM-8000FE/TW-5
 Joint size 1/4"-1/2" wide, 1/4" deep. Plank size 3" wide, 7 1/2'-38' long

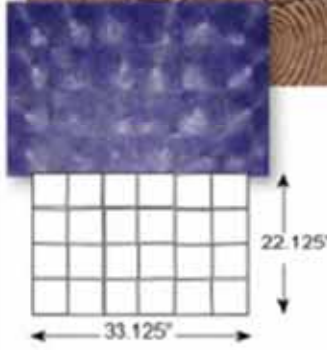

Wood Block FM-8600 S/O
 22.125" x 33.125" (56.19 x 84.13 cm)
 Blue
 Wood blocks cut perpendicular to the grain
 Matching skin/touch-up wheel:
 FM-8000FE/TW-1
 Joint size 1/4"-1/2" wide, 1/4" deep
 Block size 5 1/4" square



Bridges of Madison County

Deep in the American heartland reside the historic Bridges of Madison County. Subject of the eponymous novel, film, and musical, they are now the inspiration for Brickform's newest line of textures. These stamps were derived from real planks and timbers dating back to the late 19th century.

- 4' Wood Plank, FM-8320B S/O** *floppy available*
 15" x 48" (38.1 x 121.92 cm) Blue
 - 6' Wood Plank, FM-8420 S/O**
 15" x 72" (38.1 x 182.88 cm) Blue
 - 8' Wood Plank, FM-8520 S/O**
 15" x 96" (38.1 x 243.84 cm) Blue
 - 10' Wood Plank, FM-8620 S/O**
 15" x 120" (38.1 x 304.8 cm) Blue
- Surrounding joint depth 1/4"

Bridges Set FM-8020S includes:
 FM-8320B, Qty 1 (4') FM-8520B, Qty 2 (8')
 FM-8420B, Qty 2 (6') FM-8620B, Qty 2 (10')

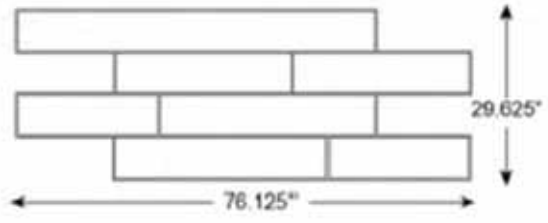

Weathered Wood Plank, FM-8750
 78.125" x 29.625"
 (193.36 x 75.25 cm)
 Yellow





16" x 16" Slate, TM-300

32" x 48" (81.28 x 121.92 cm) Pattern: A
Slate squares in two rows, with angled,
ungROUTED joints
Matching skin/touch-up wheel: Slate/TW-6
Joint size 1/2"-3/4" wide, 1/4" deep. Stone size 16" square

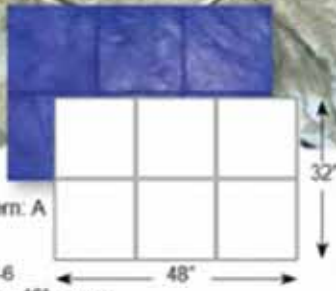

European Fan, TM-400

28" x 50" (71.12 x 127 cm) Pattern: A
Curved slate bricks gracefully arranged in a
European Fan pattern
Matching skin/touch-up wheel: Slate/TW-7
Joint size 1/4"-3/4" wide, 1/2" deep. Stone size 5 1/4"-5 1/2" wide, 4 1/4"-7" long

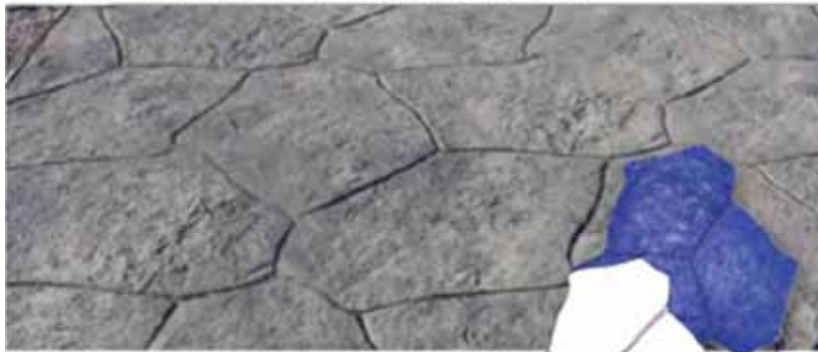
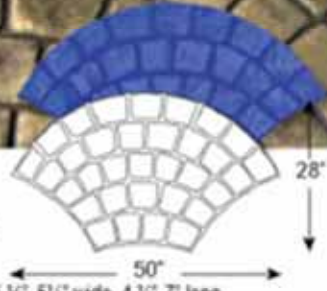

Mesa Random Stone, TM-500

61.75" x 61.75" (156.85 x 156.85 cm)
Pattern: A
Random stones sculpted to have a rough,
irregular shape. Matching skin: Mesa Stone
Joint size 1/2"-3/4" wide, 3/8" deep. Stone size 26"-30" wide, 40" long



12" x 12" Slate - 1/4" Joint, TM-600

24" x 48" (60.96 x 121.92 cm) Pattern: A
Rows of slate squares with beveled edges
Matching skin/touch-up wheel: Slate/TW-5
Joint size 1/4"-3/4" wide, 1/4" deep
Stone size 12" square

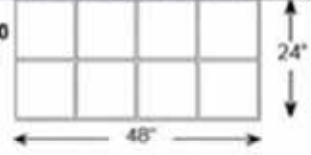

Flagstone, TM-700

48" x 48" (121.92 x 121.92 cm)

Pattern: A and B

Flagstones with hand chiseled edges grouped in a random formation.

Matching touch-up wheel: TW-6

Joint size 3/4"-1 1/2" wide, 1/2" deep

Stone size 11-21 1/2" wide, 16 1/4"-21 1/2" long

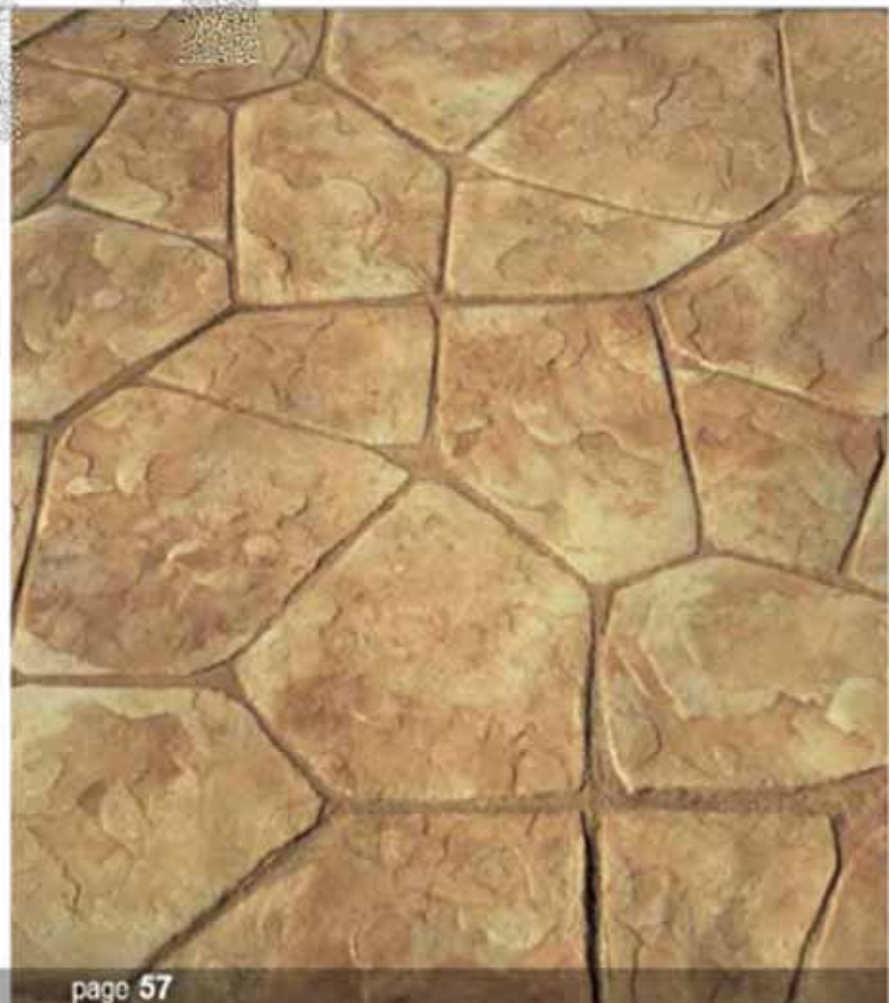
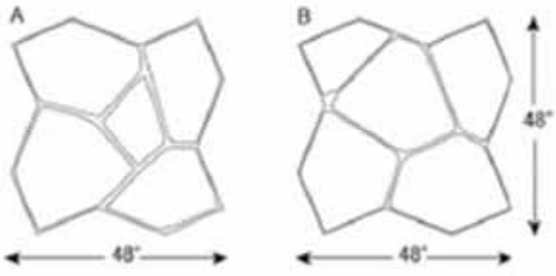
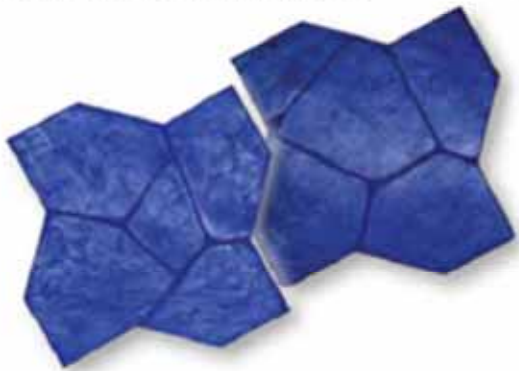



Pennsylvania Cobble
(Sanded Joint) TM-820

31.5" x 47.5" (80.01 x 120.65 cm) Pattern: A
A staggered pattern of cobblestone with sandy joints and rounded edges
Matching touch-up wheel: TW-7
Joint size 1/4"-1" wide, 1/4" deep. Stone size 4 1/2"-4 1/2" wide, 5 1/4"-9 1/4" long



Pennsylvania Station Cobble
(Smooth Joint) TM-840

53.5" x 30.875" (135.89 x 78.42 cm) Pattern: A
A staggered pattern of cobblestone with smooth joints and rounded edges
Matching touch-up wheel: TW-6
Joint size 1/4"-1" wide, 1/4" deep. Stone size 4 1/2"

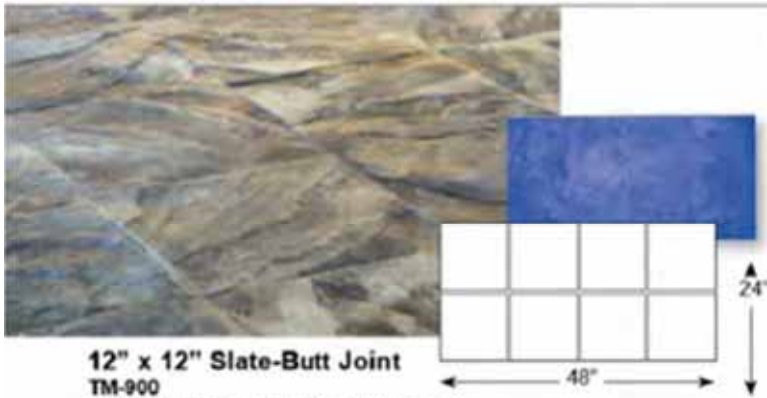

12" x 12" Slate-Butt Joint
TM-900

24" x 48" (60.96 x 121.92 cm) Pattern: A
Sharp slate squares butted up against each other in two rows
Matching skin/touch-up wheel: Slate/Chisel
Stone size 12" square

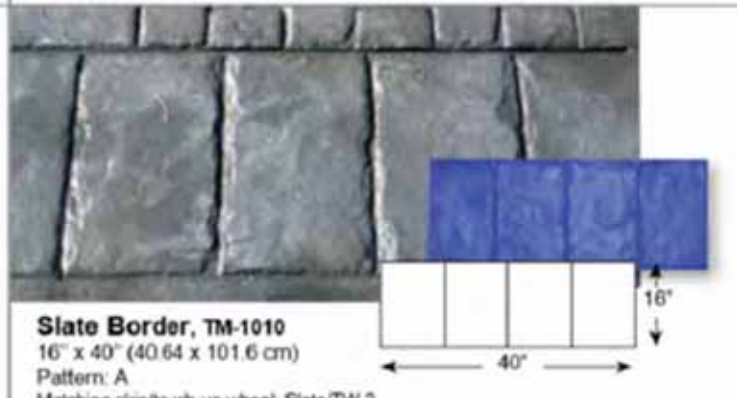

Slate Border, TM-1010

16" x 40" (40.64 x 101.6 cm)
Pattern: A
Matching skin/touch-up wheel: Slate/TW-3
Joint size 1/4"-1/2" wide, 1/2" deep
Stone size 9 1/2" wide, 15 1/4" long

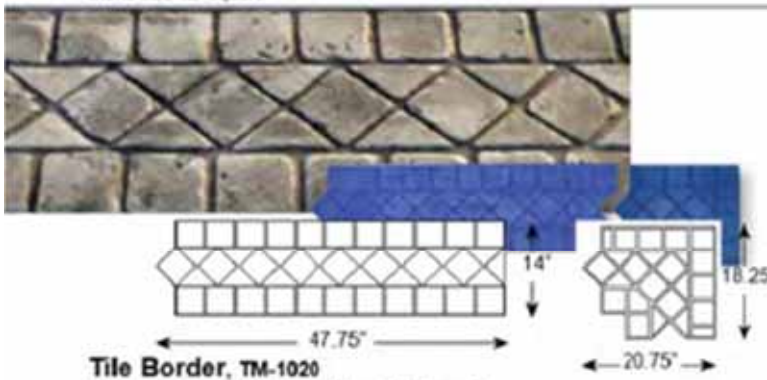

Tile Border, TM-1020

14" x 47.75" (35.56 x 121.28 cm) Pattern: A
TM-1020-1 Tile Border Corner Piece
18.25" x 20.75" (46.36 x 52.71 cm) Pattern: A
Matching touch-up wheel: TW-2
Joint size 1/4" wide, 1/4" deep. Tile size: 5" square, 4" square, 2 1/2" x 5"



Bushed Border, TM-1030

12" x 48" (30.48 x 121.92 cm)
Pattern: A
Matching touch-up wheel: TW-5
Joint size 1/2" wide, 1/4" deep. Stone size 10" wide, 22" long

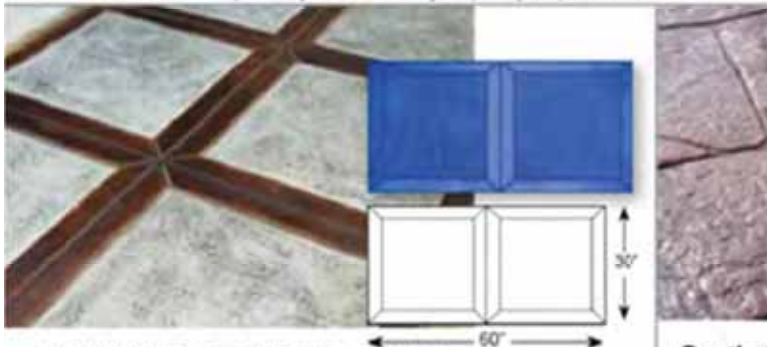

30" x 30" Bushed Stone, TM-1200

30" x 60" (76.2 x 152.4 cm) Pattern: A
Two bushed stones with square corners and sharp beveled edges
Matching touch-up wheel: TW-5
Joint size 1/4" wide, 1/4" deep. Stone size 30" square

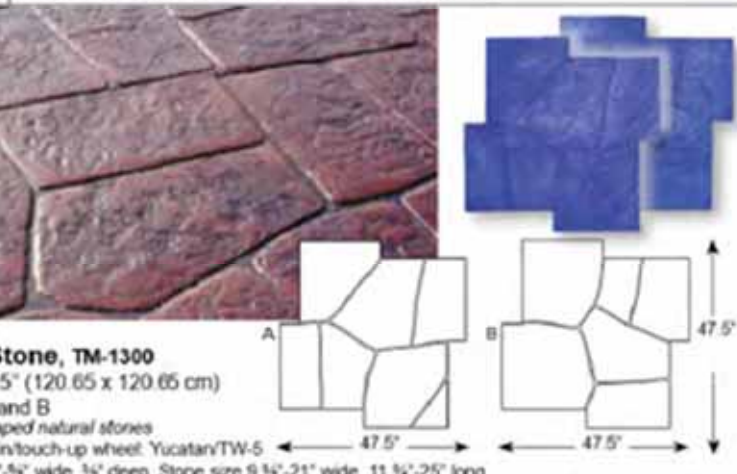

Castle Stone, TM-1300

47.5" x 47.5" (120.65 x 120.65 cm)
Pattern: A and B
Irregular shaped natural stones
Matching skin/touch-up wheel: Yucatan/TW-5
Joint size 1/8"-5/8" wide, 1/4" deep. Stone size 9 1/2"-21" wide, 11 1/4"-25" long

Creative Images Mats continued

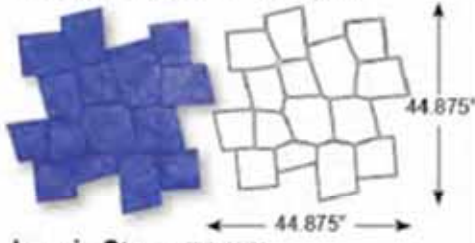

Luccia Stone, TM-1350

44.875" x 44.875" (113.98 x 113.98 cm) Pattern: A
Slate stones with irregular edges, in a random pattern
Matching skin. Smooth Slate
Joint size 1/4" wide, 1/4" deep
Stone sizes 6 1/2" x 7 1/2" to 10 1/2" x 11 1/2"

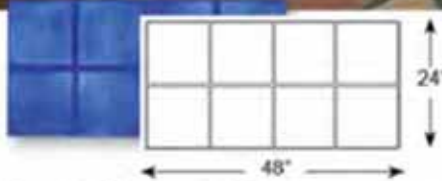

12" x 12" Mexican Tile, TM-1400

24" x 48" (60.96 x 121.92 cm) Pattern: A
Beautiful Mexican tiles with sandy joints
Matching touch-up wheel. TW-7
Joint size 1/4" wide, 1/4" deep
Tile size 11 1/4" square

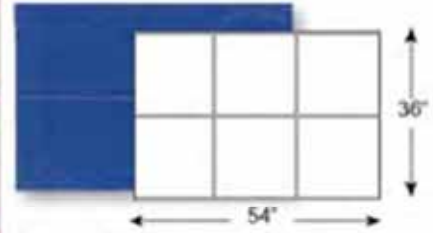

18" x 18" Slate, TM-1620

36" x 54" (91.44 x 137.16 cm) Pattern: A
Three slates with sharp edges, laid in two rows
Matching skin/touch-up wheel. Slate/TW-5
Joint size 1/2"-5/8" wide, 3/4" deep
Stone size 18" square



Verona Stone, TM-1500

42.75" x 68.5" (108.58 x 173.99 cm).
Red, Yellow and Blue
A unique random pattern of irregular stones
Matching skin/touch-up wheel. Blue Stone/TW 2-3
Joint size 1/4"-1/2" wide, 1/4" deep
Stone size 13"-21" wide, 19 1/2"-30 1/2" long

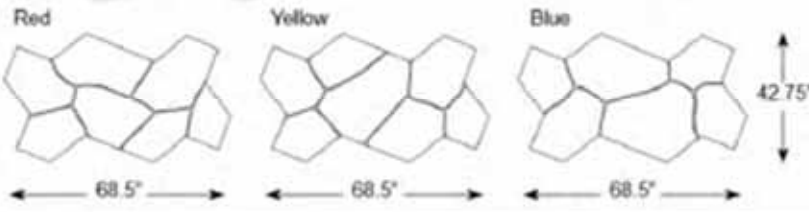

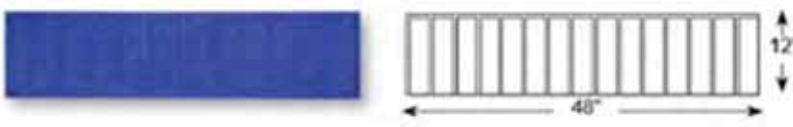

Creative Images Mats Made-to-Order  2-week production lead time

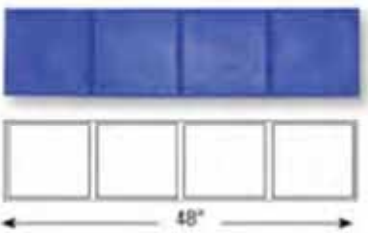

4" x 12" Brick Border, TM-1000

12" x 48" (30.48 x 121.92 cm) Pattern: A 
Matching skin/touch-up wheel. New Brick/TW-6
Joint size 1/2" wide, 3/4" deep
Brick size 3 1/2" wide, 11" long



12" x 12" Mexican Tile Border, TM-1040 

12" x 48"
(30.48 x 121.92 cm)
Pattern: A

Matching skin/touch-up wheel.
New Brick/TW-7
Joint size 1/2" wide, 1/4" deep
Tile size 11 1/4" square

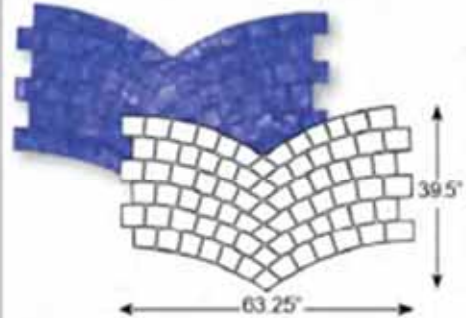

Danish Fan, TM-1100 

39.5" x 63.25"
(100.33 x 160.65 cm)
Pattern: A
Rectangular stones of various sizes laid in a fan pattern with flat joints

Matching skin/touch-up wheel.
Slate/TW-1
Joint size 1/4"-1/2", 3/4" deep
Stone size 4-4 1/2" wide, 4'-5 1/2" long

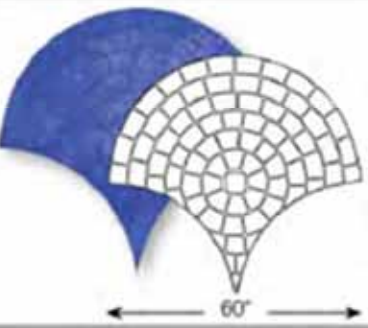

Tear Drop Fan, TM-1600 

56" x 60"
(142.24 x 152.4 cm)
Pattern: A
Utah stones laid in a teardrop fan pattern

Matching skin/touch-up wheel.
Utah Stone/TW-1
Joint size 1/2"-3/4" wide, 1/4" deep
Stone sizes vary 3 1/4" x 4 1/2" to 4 1/4" x 6 1/4"

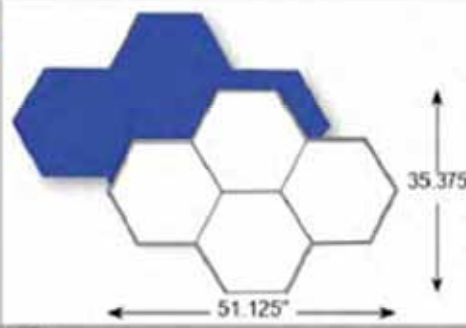

Hexagon, TM-1660 

Smooth with 1/2" Joints
35.375" x 51.125"
(89.85 x 129.85 cm)
Pattern: A
Smooth hexagon tiles in an interlocking pattern

Touch-up wheel. TW-6
Joint size 1/2" wide, 1/2" deep
Tile size 10" per side

Attachment 4 Opinion of Probable Construction Cost

Glencoe Pier Deck Replacement - Alternative 1

Baird.

**Itemized Opinion of Probable Construction Costs
Concept Design**

Project No 13359.101

Date: 12/11/2020

Item	Unit	Quantity	Unit Cost	Extension	Sub Total
1.0 General Requirements					\$46,000
1.1 Mobilization/Demobilization	LB	1	\$40,000	\$40,000	
1.2 Erosion Control	LB	1	\$6,000	\$6,000	
2.0 Site Preparation and Selective Demolition					\$8,027
2.1 Grade Sand Back	LB	1	\$870	\$870	
2.2 Demo and Dispose of Asphalt	SF	3,360	\$1.48	\$4,977	
2.3 Demo and Dispose of Handrail and Perimeter Angle	LF	404	\$6.40	\$2,181	
3.0 Deck Replacement					\$272,847
3.1 Concrete overlay, 4000psi, minimal reinforcement	CY	114	\$211	\$24,021	
3.2 Supply and Install Sleeper Brackets	EA	1,008	\$161	\$162,470	
3.3 Supply and Install 4x4 Sleepers	LF	6,040	\$4.31	\$21,736	
3.4 Supply and Install Decking	LF	14,338	\$6.21	\$74,621	
4.0 Handrail Replacement					\$31,874
4.1 Supply and install new handrails	LF	404	\$70	\$28,381	
4.2 Supply and install perimeter angle	LF	608	\$6.40	\$3,283	
5.0 Lighting					\$7,180
5.1 Add grounding to lightposts	LB	1	\$1,180	\$1,180	
5.2 Supply and install LED fixture	EA	8	\$1,000	\$8,000	

Sub-Total	\$364,738
Job Office Overhead 10%	\$36,474
Home Office Overhead & Profit 16%	\$80,182
Bond 1%	\$4,614
Total	\$488,008
Design Growth Contingency 10%	\$48,801
Owner's Contingency 5% ¹	\$25,650
Total W/ Contingencies	\$638,240
Low End Estimate (+0%) ²	\$640,000
High End Estimate (+16%) ²	\$830,000

Estimate of soft costs

Final Design and Permitting Services	\$80,000
Limited Bidding and Construction Services	\$25,000

¹ Owner's Contingency is added to account for risks attributed to the owner during construction and other change orders during construction.

² The estimate accuracy range is applied to account for the range in expected bids due to variations in contractor availability, material price fluctuations, etc.

Glencoe Pier Deck Replacement - Alternative 2

Baird.

**Itemized Opinion of Probable Construction Costs
Concept Design**

Project No 13368.101

Date: 12/11/2020

Item	Unit	Quantity	Unit Cost	Extension	Sub Total
1.0 General Requirements					\$46,000
1.1 Mobilization/Demobilization	LS	1	\$40,000	\$40,000	
1.2 Erosion Control	LS	1	\$6,000	\$6,000	
2.0 Site Preparation and Selective Demolition					\$8,027
2.1 Grade Sand Back	LS	1	\$870	\$870	
2.2 Demo and Dispose of Asphalt	SF	3,360	\$1.48	\$4,977	
2.3 Demo and Dispose of Handrail and Perimeter Angle	LF	404	\$6.40	\$2,181	
3.0 Concrete Deck Overlay					\$83,666
3.1 Concrete overlay, 5000 psi, reinforced	CY	146	\$242	\$36,088	
3.2 Slab texture stamping	SF	8,720	\$7.21	\$48,468	
4.0 Handrail Replacement					\$32,880
4.1 Supply and install new handrails	LF	404	\$70	\$28,381	
4.2 Supply and install perimeter angle	LF	608	\$7.36	\$4,489	
5.0 Lighting					\$7,180
5.1 Add grounding to lightposts	LS	1	\$1,180	\$1,180	
5.2 Supply and install LED fixture	EA	8	\$1,000	\$8,000	

Sub-Total	\$176,833
Job Office Overhead 10%	\$17,883
Home Office Overhead & Profit 16%	\$29,144
Bond 1%	\$2,234
Total	\$226,876
Design Growth Contingency 10%	\$22,687
Owner's Contingency 6% ¹	\$12,412
Total W/ Contingenoes	\$280,664
Low End Estimate (+0%) ²	\$270,000
High End Estimate (+16%) ²	\$320,000

Estimate of soft costs

Final Design and Permitting Services	\$80,000
Limited Bidding and Construction Services	\$26,000

¹ Owner's Contingency is added to account for risks attributed to the owner during construction and other change orders during construction.

² The estimate accuracy range is applied to account for the range in expected bids due to variations in contractor availability, material price fluctuations, etc.



As an engineer with Baird, Mr. Barth has been extensively involved in a variety of multi-disciplinary projects in the Great Lakes, Atlantic Coast, Gulf of Mexico, Caribbean, Africa, and Australia. Mr. Barth is experienced in the design of port and harbor infrastructure, waterfronts, and a variety of hard and soft solutions for coastal erosion. As project manager, Mr. Barth has led teams of multi-disciplinary teams and delivered projects from concept to construction on budget. Mr. Barth is experienced in constructability reviews, cost estimating, permitting, and construction field support.

12 YEARS' EXPERIENCE

Coastal Structures
Cost Estimating
Project Delivery

EDUCATION

B.Sc. | Civil Engineering

AFFILIATIONS

Registered Professional Engineer:
Illinois, Wisconsin

PROJECT EXPERIENCE

New York/ New Jersey Harbor & Tributaries Study (HATS) | NY/NJ, USACE – New York District | 2019-Present

The New York District (NYD) Corps of Engineers is conducting a feasibility level study to advance the conceptual design of the New York New Jersey Harbor and Tributary Study (HAT Study) structural flood risk features. Mr. Barth was the cost estimate Task Leader the HAT Study which included advancing five alternatives consisting of an array of Storm Surge Barriers (SSB's) and Shore-Based Measures (SBM's) to determine a Tentatively Selected Plan (TSP).

Marina Revetment and Breakwater Repairs | Hammond, Indiana, Lake Michigan | Hammond Port Authority | 2016-Present

Project Manager providing field investigation, permitting, final design, bidding, quarry quality assurance, and construction administration services for repairs to 1,100 feet of rubblemound breakwater, repairs to 700 feet of rubblemound revetment, the installation of a new 500 feet long cast-in-place concrete sea wall, and the extension of an existing intake pipe relieving platform.

Highland Park Lakefront Interceptor Protection | Highland Park, Illinois, Lake Michigan | North Shore Water Reclamation District | 2017-Present

Project Manager providing field investigation, permitting, and final design services for the protection of an existing sanitary sewer interceptor that runs parallel to the beach on Lake Michigan. The project entails the installation of approximately 1,000 ft of shoreline protection, consisting of a series of detached armor stone breakwaters, shore-tied armor stone groins, and associated pocket beaches.

Living Breakwaters | Staten Island, NY, Raritan Bay | Governor's Office of Storm Recovery | 2018-Present

Baird is the construction manager to facilitate the construction of a series of breakwaters designed to buffer neighborhoods from wave damage and erosion while providing a more biodiverse habitat for juvenile fish, oysters, and other organisms. Mr. Barth was responsible for value engineering, procurement support, and contractor selection. Mr. Barth will be the Deputy Resident Engineer when construction starts in the second half of 2021.

Town Docks Replacement | Town of Palm Beach, Florida | 2018-Present

Baird provided master planning, regulatory, final design, bidding, and construction services for the replacement of the dockage system. The overhaul includes removing the existing fixed dock system and replacing it with a state-of-the-art floating docks system that can accommodate mega-yachts up to 250 feet in length. Mr. Barth provided structural engineering services for the floating dockage anchorage and developed the performance specifications.

Barbados Resort | Barbados, West Indies | Confidential Client | 2017-2019

Baird's client is developing 500m of coastline as part of a new resort in Barbados. Baird undertook design and permitting work to support shoreline enhancement including protection of the existing natural reef. Mr. Barth provided structural engineering services for the design of an 85-meter long pier and an emergent offshore breakwater overlook structure and technical support during construction.

Eagle Lake Park Evaluation | Kansasville, Wisconsin | Racine County | 2015-Present

Project Manager providing field investigation, permitting, and final design services for the replacement of a failing sheet pile retaining wall and the expansion of a boat launch. Additionally, Baird will provide bidding and construction observation services when the project advances into construction.

Fish Creek Beach Improvements | Fish Creek, Wisconsin, Lake Michigan | Short, Elliot, Hendrickson, Inc | 2018

Project Manager and Technical Lead for coastal and structural engineering services for the development of alternatives to improve and expand the existing beach and for the addition of a public viewing pier at the public beach. In addition, Mr. Barth facilitated public board meetings to establish aesthetic and functional criteria.

Lyon Square Riverfront Park | Grand Rapids, Michigan, Grand River | Bishop Land Design, LCC | 2017-2018

Baird provided marine and structural engineering services for the preliminary design of the redevelopment of the waterfront on the Grand River. As lead engineer, Mr. Barth assisted with the development of concepts for a tiered floating promenade to facilitate public access to the river and proposed kayak/rafting class 3 rapids. Services provided included regulatory input and a class 3 opinion of probable construction cost.

East Chicago Marina | East Chicago, Indiana, Lake Michigan | City of East Chicago | 2016-2017

Baird provided engineering services for the replacement of a 292-slip marina on the southern end of Lake Michigan. Mr. Barth was the structural engineer and developed the performance specifications for the total dockage system replacement.

Whitebridge Hill Beach House Lakefront Improvements | Winnetka, Illinois, Lake Michigan | Northworks, Architects and Planners, LLC | 2015-2017

Baird provided engineering, permitting, and construction phase services for the design of a stone beach retention groin, steel sheet pile pier structure, and backshore bluff protection soldier pile wall. Mr. Barth provided structural design services for the steel sheet pile pier and backshore soldier pile wall structures and construction observation services for the construction of the stone groin.

Bay Moorings | Penetanguishene, Ontario, Georgian Bay, Lake Huron | Parkbridge Lifestyle Communities Inc. | 2016-2017

Baird provided an evaluation of the existing breakwater at a marina and provided concept designs and costs for an upgraded structure. Mr. Barth provided conceptual structural design services and developed preliminary opinions of construction cost for each alternative.

Coastal Risk Assessment and Management Program | Barbados, West Indies | Coastal Zone Management Unit | 2016-2017

The Coastal Risk Assessment and Management Program (CRMP) was established to help the government of Barbados understand the island's exposure and resiliency to hurricanes, sea level rise, storm surge, terrestrial loads and water quality. As lead structural engineer, developed designs for a waterfront project which consists of 1,000 meters of boardwalk, piers, and shore protection along the island's southern coast.

Bluff Crib Wall Replacement and Drainage Improvements





Over 220 ft of crib wall replacement, improved entryway at water plant and drainage solutions for the bluff and Hazel



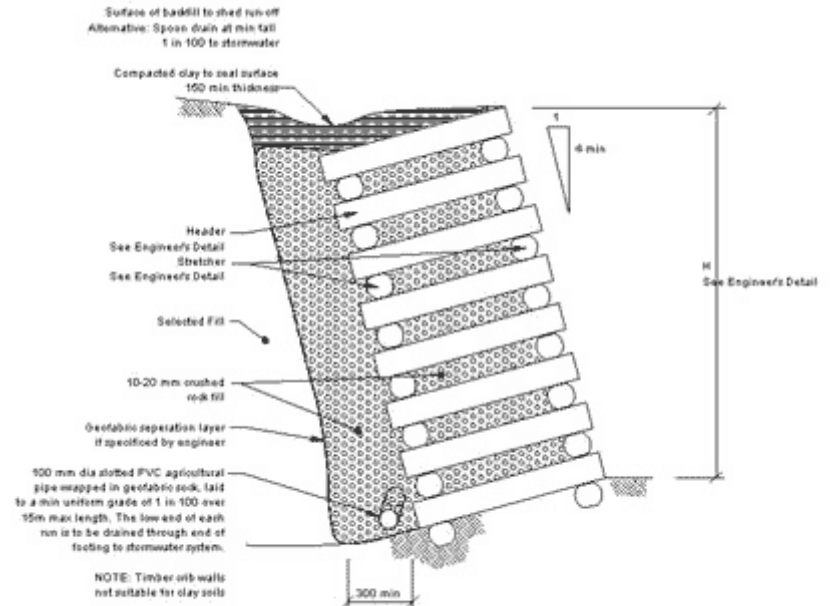

02 2023 Design Detail & Detail Pg 12
04/2023

Timber Crib Retaining Wall Detail

Crib walls are one of the oldest gravity wall systems. A series of stacked members create hollow cells that are filled with soil or rock



This what ours looks like



It ranges in height from 2 ft approx. to over 10 ft holding back the entire northeastern bluff

NOTICE
AUTHORIZED
VISITORS ONLY
PRESS CALL BUTTON
FOR RESPONSE

CAUTION

DO NOT
CLIMB
OR
RELY ON THIS GATE





Approach and Entry to
Water Plant

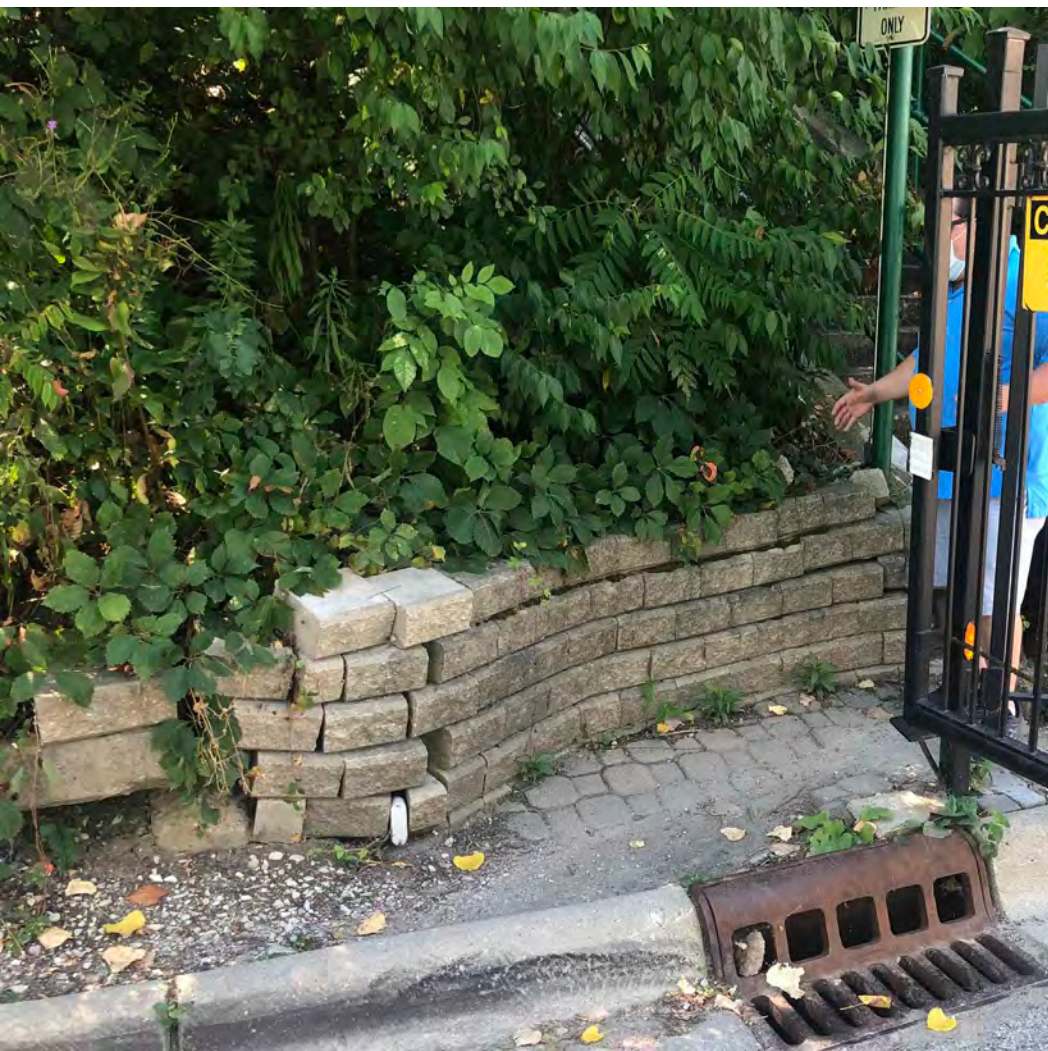

A mixture of systems and materials at the entry gate to Water Plant

