

Dog Park in Glencoe?



Review of Process

- The Park District held a community meeting on the desire for a dog park.
- Attendees indicated appropriate spots for a dog park by placing dots on a map.
- The Board reviewed all suggestions and determined six locations met the criteria.
- The Board formed a task force to study the viability of six locations.



Task Force

- The task force visited and discussed the potential locations.
- They unanimously determined the south-side Shelton Park location best met the criteria.
- A survey was hand-delivered to 70 neighbors in the area surrounding the site.



Dog Park Task Force Conclusion

- There was a consensus on the task force that a dog park is a desired amenity for Glencoe.
- However, after reflecting on the survey results they reluctantly concluded they would not recommend a dog park within Glencoe Park District property.
- The task force believes that the Cook County Forest Preserve has adequate nearby property for a dog park.
- Recommendation: That a citizen group should be formed with residents of Winnetka, Northfield, and Glencoe to request the Cook County Forest Preserve consider a dog park on forest preserve land in our area.



Thank You

Thank you to our
volunteer task force
for their countless hours of meetings
and dog park tours.



Appendix

Visit www.GlencoeParkDistrict.com to find more information on dog park discussion:

Under Transparency Portal / Board or Committee:

- Dog Park Community Meeting Minutes - February 12, 2019
- Special Projects Committee Meeting Minutes - March 05, 2019
- Committee of the Whole Meeting Minutes - May 7, 2019
- Committee of the Whole Meeting Minutes - January 7, 2020

Under News:

- <https://www.glencoeParkDistrict.com/news/special-projects/dog-park-feasibility>



Dog Park Criteria

The Board of Park Commissioners then discussed and set other site selection criteria including:

- A dog park should not directly abut a residence
- Safe and accessible parking
- Avoid locations that share an entrance with a children's play area
- Minimum impact on visual character of the park
- If the park is activated for other uses, avoid any area with potential for congestion
- Optimal size for fenced-in area is one acre (or more)



Board of Park Commissioners

Discuss Dog Park

The following sites were eliminated from consideration:

Takiff Park: Eliminated due to athletic field/walking path/parks operations center

Friends Park: Eliminated due to playground

Berlin Park: Eliminated due to athletic fields

Woodlawn Park: Eliminated due to playground

Old Elm Park: Eliminated due to playground

West Park: Eliminated due to playground

Watts Athletic Fields: Eliminated due to athletic fields

Glencoe Beach – in season: Eliminated due to operational beach

Kalk Park: Eliminated due to gazebo/special event space

Veterans Memorial Park: Eliminated due to special use space

Vernon Playground: Eliminated due to playground

Everly Wildflower Sanctuary: Eliminated due to active naturalized area



Board of Park Commissioners

Discuss Dog Park

After viewing all possible sites owned by the Glencoe Park District that were one acre or above, the Board of Park Commissioners narrowed down the choices to six possible sites to explore further. Those sites were:

- **Park 7n and 8n:** located at the intersection of Old Green Bay Road and Maple Hill Road
- **Park 3n “Sunken Park”:** located east of Old Green Bay Road and north of Dennis Lane
- **Watts Park:** not including the athletic fields, located at 461 Jackson Avenue
- **Shelton Park:** located at 251 Harbor Avenue, focus on southwest portion of the park
- **Park 21s2 and 22s:** adjacent to the Linden House, located at Linden and Jackson Avenues
- **Park 10s:** located at Green Bay Road and South Avenue



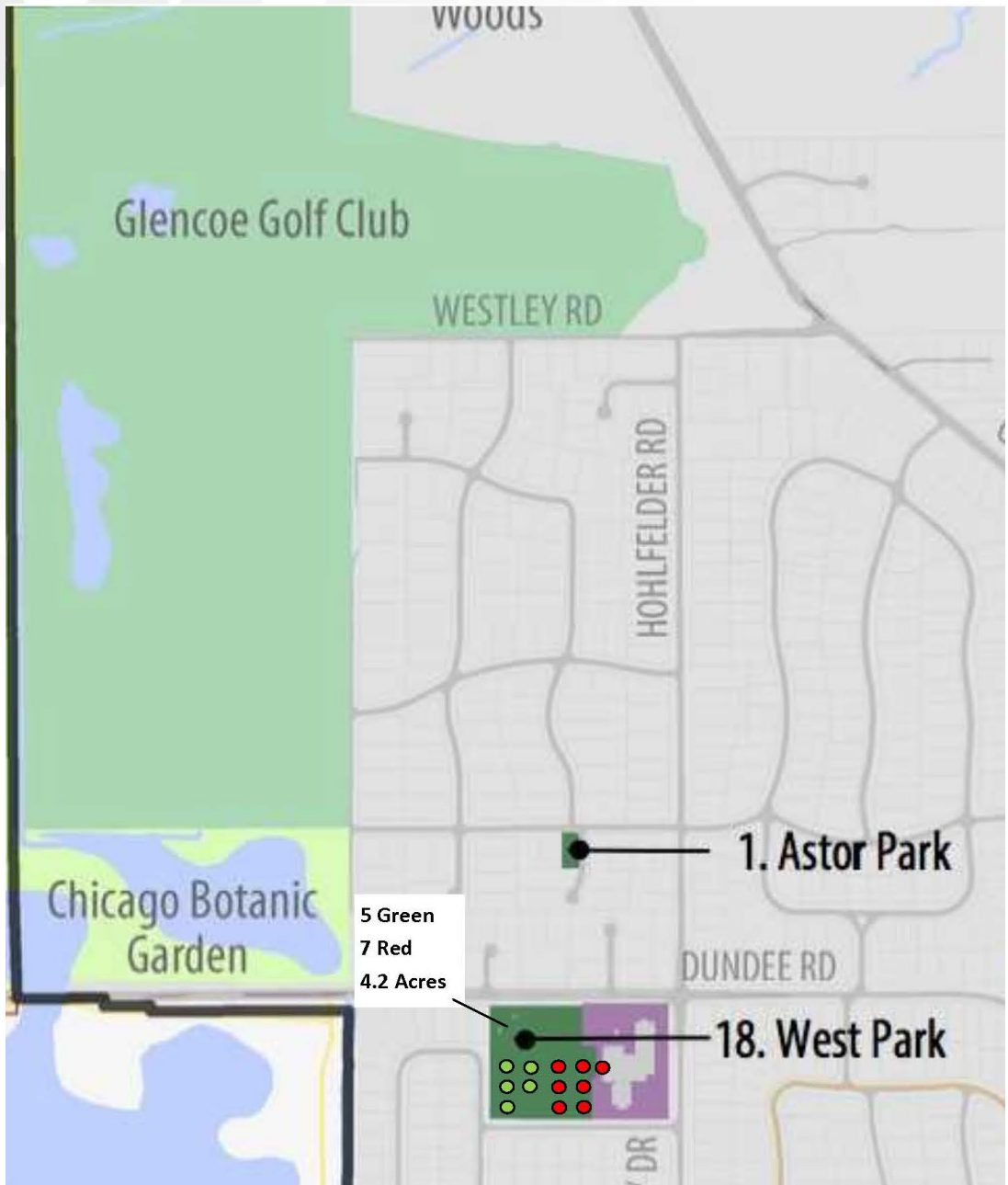

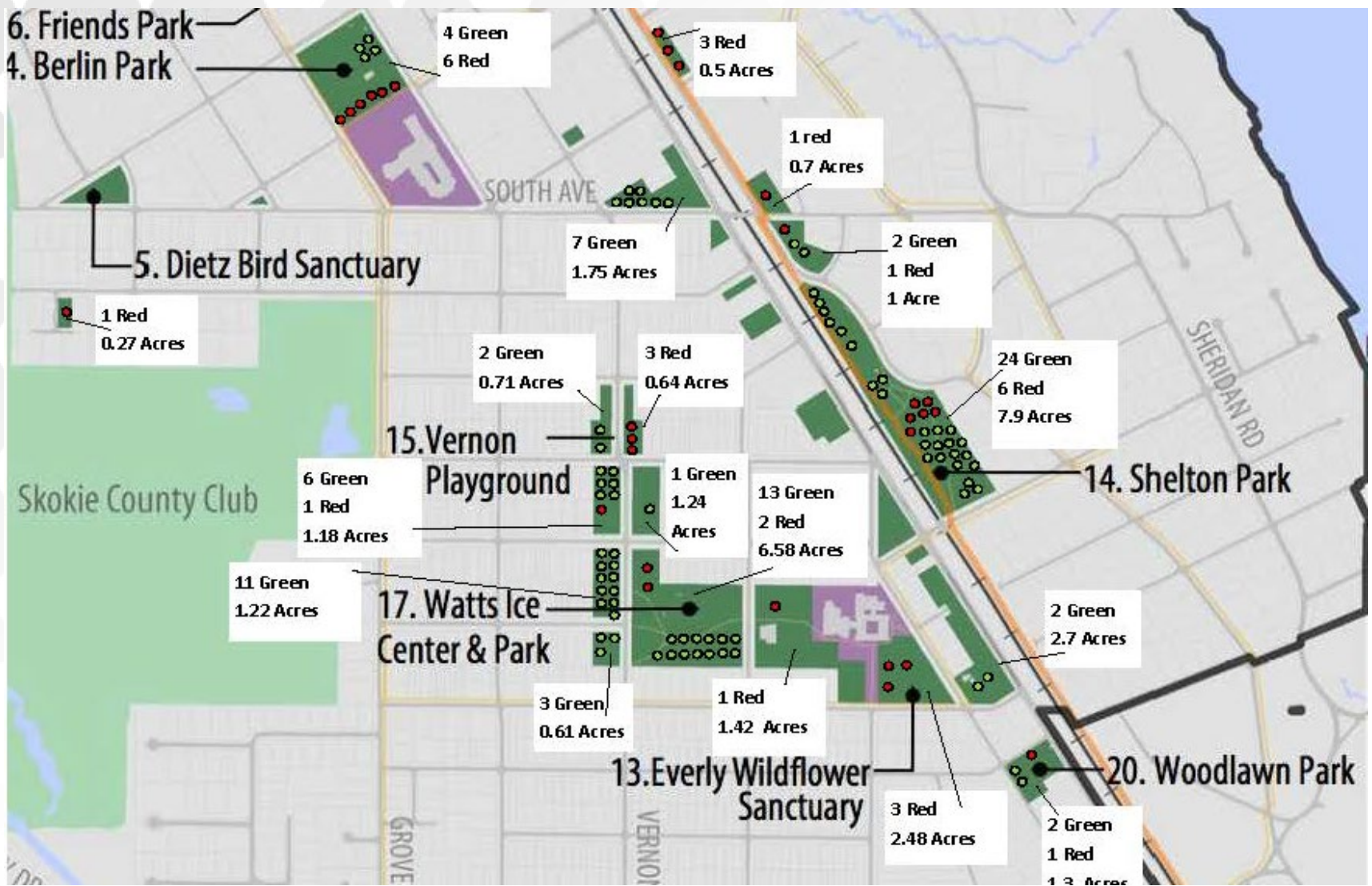

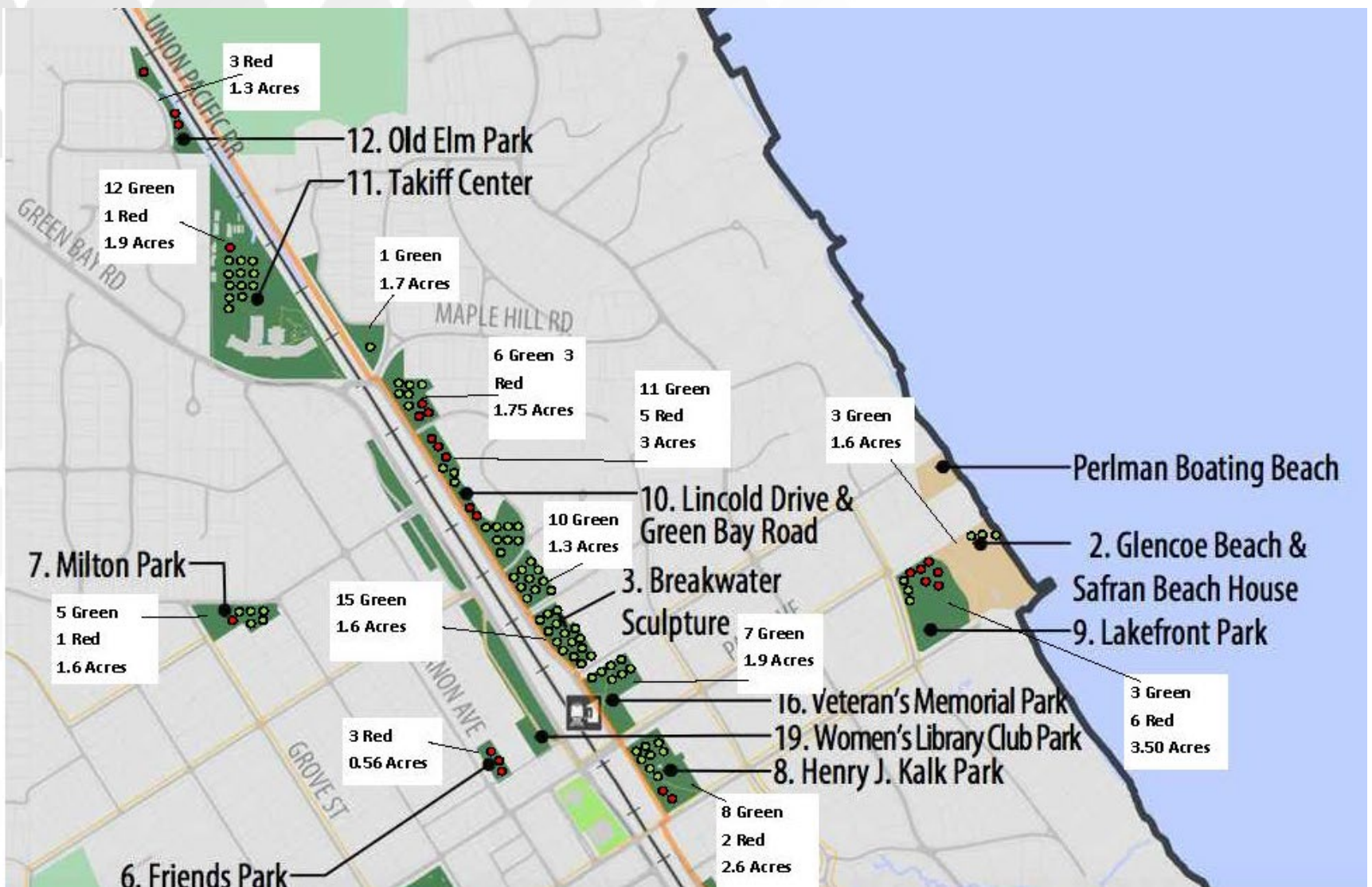



Enriching lives and creating memorable experiences.



Park 7n and 8n



- Triangle property
- Backs up to Green Bay Trail/tracks, and a park
- Across the street from 5-6 single family homes
- 1.7 acres



Park 7n and 8n

Task Force Pro/Con List

PROS

Member #1

- No tree removal

Member #2

- Train to drown out noise
- Houses are less
- Big shrubs on house across street
- Parking at Takiff
- Minimal impact (relatively) on population
- Good size

Member #3

- Easy access from Green Bay Trail

Member #4

- Only one house is close
- Parking at Takiff or acquire spaces related to train on Old Green Bay
- Fairly central in the community near Takiff

Member #5

- One house impacted only
- Takiff Center parking lot

Member #6

- Not on a major through street
- Screened/good distance from houses
- Not near playgrounds
- Shady sections

Member #7

- Impacts few homes

Member #8

- Only one impacted house

Member #9

- Few (2) homes nearby

Member #10

- Train and Green Bay
- Trail
- Impacts one house
- Good bushes

Member #11

- Impacts one house

CONS

Member #1

- Parking—designate with Village along inner Green Bay
- Three houses across the street

Member #2

- Parking on street

Member #3

- House very close by
- Smaller Size
- Street parking only
- Heavy traffic on main road
- Smaller size

Member #4

- Limited parking
- Need substantial screening on Meadow Road
- Might need dog turf
- Small

Member #5

- Nearby parking, but...

Member #6

- Not much parking; street only
- Small

Member #7

- Parking
- May be small

Member #8

- Too small

Member #9

- Limited parking nearby on street

Member #10

- Home across street
- Parking not good
- Small

Member #11

- Parking difficult, maybe get parking spots from train parking
- Small



Park 3n “Sunken Park”



- One of a series of parks on Old Green Bay Road
- Backs up to residents, two parks, and railroad tracks
- Area recently approved for trail and playground project
- 1.3 acres



Park 3n “Sunken Park” Task Force Pro/Con List

PROS

Member #1

- Parking

Member #2

- Parking
- Seclusion from housing
- Size

Member #3

- -

Member #4

- No homes about the park
- Good size
- Relatively central!
- Ties into Green Bay Trail

Member #5

- Good parking
- Large

Member #6

- Train lot parking (after 10 on weekends)
- Shady sections (existing trees)

Member #7

- Large area
- Only impacts two houses?

Member #8

- Few houses

Member #9

- Parking on Old Green Bay Road after 10

Member #10

- Good size
- Seems isolated, less neighbors
- Good parking??
- Hardly used!!

Member #11

- Better parking

CONS

Member #1

- Trail will reduce space available

Member #2

- -

Member #3

- Only open play space in this area
- Neighbors already upset with walking trail
- House close by, no barrier in winter

Member #4

- Drainage
- No shade
- Neighbors not happy

Member #5

- Neighbors

Member #6

- Proximity to future park/splash pad
- Conflict with forthcoming paths/changes
- Hostile neighbors

Member #7

- Drainage issue
- Big open field for kids to play
- Will ultimately be small

Member #8

- Drainage issues
- Will be used for path

Member #9

- Drainage
- Size—small
- Neighbors concerned about noise

Member #10

- Only open space on this side of town

Member #11

- Very close to houses



Watts Park



- Not on athletic fields
- Street parking
- No drinking fountain



Watts Park

Task Force Pro/Con List

PROS

Member #1

- -

Member #2

- -

Member #3

- Already a recreational area
- Lots of parking

Member #4

- Over an acre, good size
- Already noisy as park use
- Parking available
- Shade

Member #5

- -

Member #6

- Bigger
- Tree buffer to houses
- Already established as noisy (hockey, ball, etc.)
- Shady sections/existing trees

Member #7

- Large rec space

Member #8

- No houses

Member #9

- Size

Member #10

- Parking seems good
- Good size
- Good for limited hours
- Low neighbor impact

Member #11

- Great area
- Already noisy as park use

CONS

Member #1

- Moving current activity to less desirable area
- Already much activity for this neighborhood

Member #2

- Parking
- Frisbee golf
- Sled Hill
- School proximity

Member #3

- Frisbee golf would move
- Already a recreational area

Member #4

- Would have to relocate Frisbee golf

Member #5

- Move Frisbee golf

Member #6

- Moving Frisbee golf/sled hill

Member #7

- Busy park
- Parking
- Would have to relocate Frisbee golf

Member #8

- Have to move Frisbee golf

Member #9

- Sledding hill, Frisbee golf
- Neighbors
- Parking when heavily used

Member #10

- Relocate golf
- Move golf

Member #11

- Move Frisbee golf
- Parking



Shelton Park



- Southwest, closest to the tracks



Shelton Park Task Force Pro/Con List

PROS

Member #1

- Parking
- Dogs can get in and play when walking along Green Bay Trail
- Train noise already

Member #2

- Less homes impacted (2-4 homes)

Member #3

- There's space away from houses
- Good parking
- Easy access of Green Bay Road

Member #4

- Good space
- Parking
- Could use a more secluded portion of this
- Nice tie in to the Green Bay Trail
- Shade

Member #5

- -

Member #6

- Bigger
- Differing grades and existing trees
- Various parking options
- Not near too many houses
- Doesn't front on major street
- Parking

Member #7

- More space to work with—can fix drainage and maybe redirect path
- Parking
- Along Green Bay Trail

Member #8

- -

Member #9

- Parking on Village lot?
- Known park
- Hidden and quiet
- Away from school

Member #10

- Could have parking on west side if Village put snow elsewhere
- Good parking

Member #11

- Impacts least amount of houses
- Good parking
- Good place to build berm
- Adjacent to Green Bay Trail
- Wonderful place to build a park

CONS

Member #1

- -

Member #2

- -

Member #3

- There are a few houses who would be impacted

Member #4

- Some houses

Member #5

- -

Member #6

- Hostile neighbors?

Member #7

- Impact several houses

Member #8

- -

Member #9

- -

Member #10

- Neighbors to east have complained in past

Member #11

- -



Park 21s2 and 22s



Park 21s2 and 22s

Task Force Pro/Con List

PROS

Member #1

- Buffer of Green Bay Road and train + north side park area

Member #2

- -

Member #3

- Not as many houses—just one side
- More open space
- Shady

Member #4

- Very large
- Not much residential conflict
- Screening belongs to park district
- Good size

Member #5

- -

Member #6

- Existing trees; shady sections
- No neighbors on two sides
- Bigger

Member #7

- Large area
- Busy (noisy) due to train and Green Bay
- Shaded with trees

Member #8

- -

Member #9

- Parking on street on weekends
- Opportunities for long narrow run away from houses
- Parking opportunity on south Linden

Member #10

- Next to Green Bay
- Good size
- Nice land

Member #11

- Large parcel
- Would be a good buffer

CONS

Member #1

- Parking?

Member #2

- Lots of homes
- Off leash dog on Green Bay
- South School safety proximity
- Parking

Member #3

- Parking tough here

Member #4

- Parking limited!
- Busy street if dog escapes
- Noisy

Member #5

- Parking—re: South School

Member #6

- Fronts on Green Bay; dangerous if dogs escape/gates left open
- Proximity to school
- Parking limited/congestion

Member #7

- Parking
- Impacts several homes
- Near school

Member #8

- Parking is very limited

Member #9

- Neighbors
- Parking during school days limited

Member #10

- Homes
- Parking

Member #11

- Parking huge problem



Park 10s



Park 10s

Task Force Pro/Con List

PROS

Member #1

- Shady
- OK parking on street

Member #2

- Size

Member #3

- -

Member #4

- Larger
- Green Bay already has noise
- Good parking
- Shade
- Have to fix the drainage anyway

Member #5

- Size
- Nearby parking

Member #6

- Bigger
- Near train, so neighbors used to noise?
- Side street parking
- Not near playgrounds
- Varied topography: different grades, existing trees

Member #7

- Large area
- Already a busy area

Member #8

- -

Member #9

- Parking available

Member #10

- Next to Green Bay Road
- Live near train
- Good size

Member #11

- Large property
- Parking better

CONS

Member #1

- Extremely poor drainage
- Abuts one house
- Across street from five houses
- Distractions from Green Bay Road

Member #2

- Denser homes
- Central School traffic

Member #3

- Lots of houses
- Busy street Right of Green Bay Road—could impact traffic

Member #4

- Lots of houses across the street
- Water issues

Member #5

- South Avenue neighbors

Member #6

- Close to houses
- Fronts on Green Bay: dangerous if dogs escape/ gates left open

Member #7

- Very poor drainage
- A lot of work
- Impacts several houses
- Ducks
- Already a busy area

Member #8

- Needs a lot of drainage

Member #9

- Drainage
- Nearby houses
- Traffic on Green Bay Road

Member #10

- Parking not great
- Water improvement
- Lots of houses (on south side, one house right on site, north side)

Member #11

- -



October 14, 2019

Dear Neighbor,

The Glencoe Park District (GPD) Board of Commissioners formed a volunteer task force to address resident requests for a dog park in Glencoe. A dog park was a top priority on Glencoe's 2014 Master Plan community survey and has been a consistent request since then. Nationally, dog parks are now one of the most desired park amenities.

The objective of the task force is to find a location on GPD property that meets basic criteria for this new amenity, such as adequate open space and nearby parking, and on land not currently activated for another recreational use. After evaluating 23 potential sites chosen from resident input at a public meeting, the location unanimously chosen by the task force to further explore is in the SW corner of Shelton Park as shown in the attached rendering. The attached is a basic rendering of the potential location and size. The design attributes would include quality fencing, drainage, landscaping, and a variety of different surface materials such as grass, artificial grass, or crushed granite surface. This is the just the first step in a process that will require the Board to determine funding.

The task force is interested in hearing from neighbors in the area around the potential dog park and has created this survey to better understand your opinions and any potential concerns. Please take some time to complete the survey and return it to the GPD in the stamped addressed enclosed envelope. The survey is also available online at <https://www.surveymonkey.com/r/GPDdogs>. Please use the code **GPDdogpark** (case sensitive) to complete the survey. The deadline for the survey to be returned is Monday, November 4.

The Task Force will discuss the opinions shared in the survey, prior to making any recommendations to the Board of Park Commissioners. The Task Force will report their findings and their recommendations at a public meeting later this year. If you would like to be notified of the meeting, please include your email address on the survey.

Thank you for helping us by taking the time to share your thoughts. If you have any questions, feel free to contact info@glencoeParkdistrict.com or (847) 835-3030.

Best,

Glencoe Park District Dog Park Task Force



PLEASE SHARE YOUR OPINION ON A POTENTIAL DOG PARK IN SHELTON PARK AT THE LOCATION SHOWN ON THE RENDERING ATTACHED TO THIS SURVEY.

The results of this survey and comments will be shared with the task force and at a public meeting but names will be withheld.

Please fill out a separate survey for every adult over 21 in your household or indicate below both names if views are shared by both 21 and over residents.

First Name(s): _____ Last Name(s): _____

Address: _____

Are you a neighbor of Shelton Park? Yes No

Have you ever been to a dog park before? Yes No

Do you think Glencoe could benefit from an area where dogs could safely play off-leash? Yes No No opinion

What benefits could a dog park bring to Glencoe?

(Rate the strength of your opinion: 1 – no benefit, 5 - high benefit and 3 – neutral/ambivalent)

- ____ Socialization for dogs ____ Socialization for humans
____ Exercise and enrichment for dogs ____ Builds a sense of community
____ Gives dogs a safe space to exercise and roam freely
____ Improves desirability of Glencoe to potential buyers (newcomers)
____ Other: _____

What concerns do you have for a dog park in the location shown on the rendering attached to this survey?

(Rate the strength of your opinion: 1 – no concern, 5 - high concern and 3 – neutral/ambivalent)

- ____ Dog conflicts ____ Noise
____ Parking and congestion ____ Trash
____ Odor ____ Hours of operations
____ Location (proximity to houses) ____ Dogs getting loose
____ Change of landscape/view ____ Impact on property value for homes near dog park
____ Other? _____

Would you support a dog park in the area shown on the rendering? Yes No No opinion

If no, let us know if anything could be done to make this area acceptable: _____

If you would like to be contacted about future dog park discussion at regular board or committee meetings, please share your email address here (your e-mail address will not be shared): _____

If you would like to have personal discussion on this potential project please indicate your phone number below. We will call you to discuss the project in more detail. _____

We want to make sure we make every effort to reach all of our Shelton Park neighbors, so if you know of a neighbor who is not home for an extended period of time, please let them know to contact us and we will e-mail or mail a copy.



Survey Results

Q2 Are you a neighbor of Shelton Park?

Answered: 53 Skipped: 0

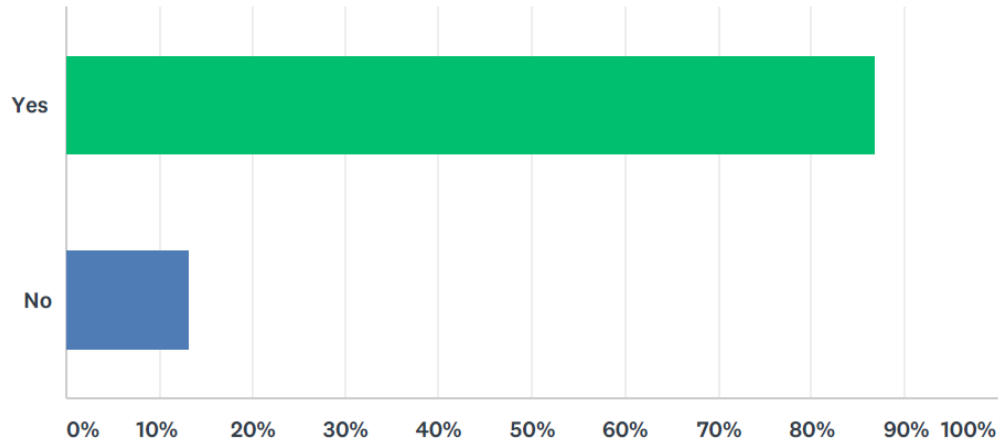

ANSWER CHOICES	RESPONSES	
Yes	86.79%	46
No	13.21%	7
Total Respondents: 53		



Survey Results

Q3 Have you ever been to a dog park before?

Answered: 53 Skipped: 0

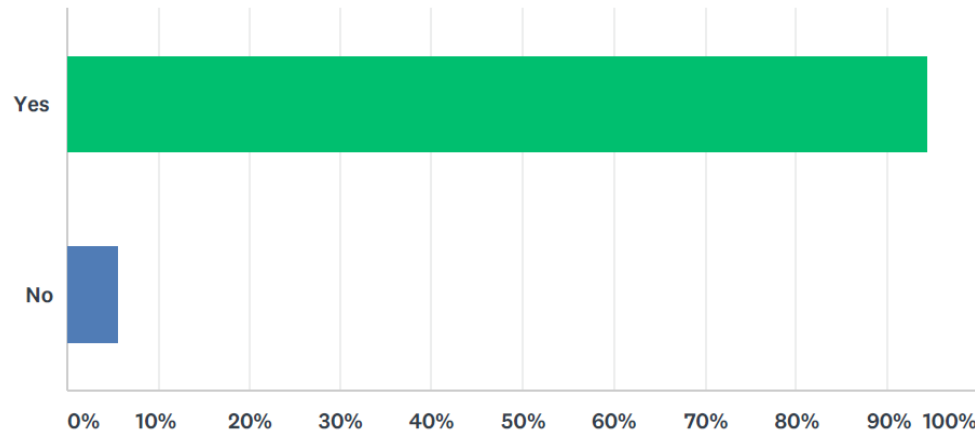

ANSWER CHOICES	RESPONSES	
Yes	94.34%	50
No	5.66%	3
Total Respondents: 53		



Survey Results

Q4 Do you think Glencoe could benefit from an area where dogs could safely play off-leash?

Answered: 51 Skipped: 2

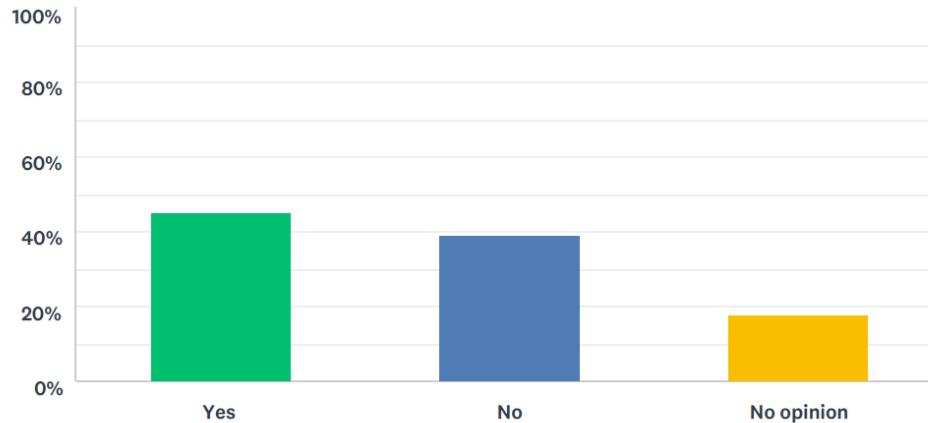

ANSWER CHOICES	RESPONSES	
Yes	45.10%	23
No	39.22%	20
No opinion	17.65%	9
Total Respondents: 51		



Survey Results

Q5 What benefits could a dog park bring to Glencoe? (Rate the strength of your opinion: 1 – no benefit, 5 - high benefit and 3 – neutral/ambivalent)

Answered: 50 Skipped: 3

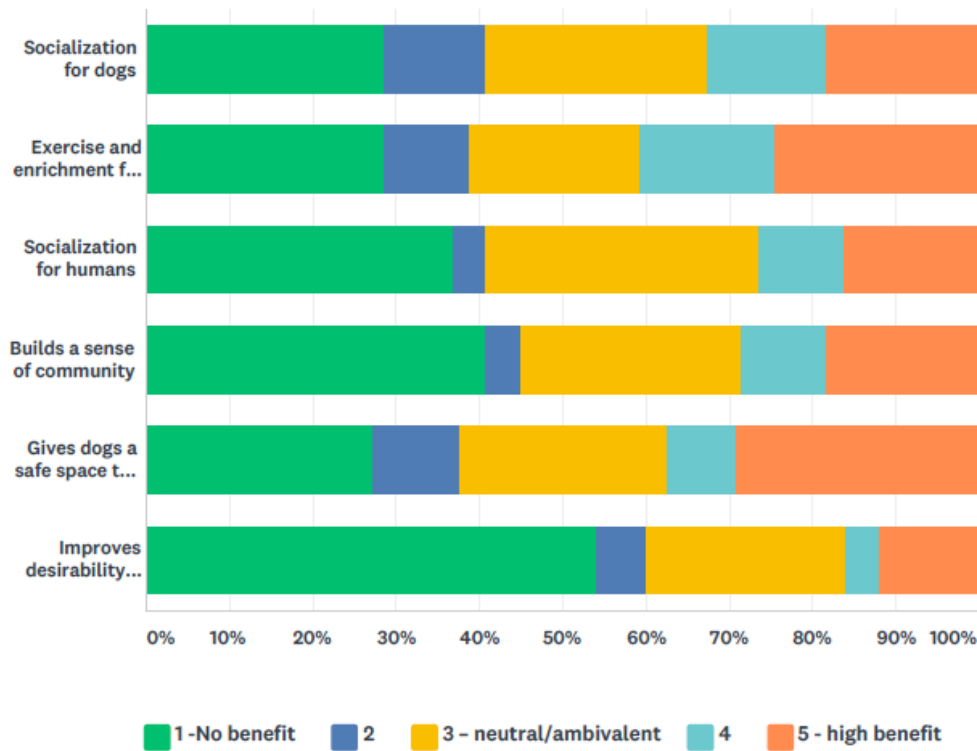

Survey Results

Q5 What benefits could a dog park bring to Glencoe? (Rate the strength of your opinion: 1 – no benefit, 5 - high benefit and 3 – neutral/ambivalent)

	1 -NO BENEFIT	2	3 – NEUTRAL/AMBIVALENT	4	5 - HIGH BENEFIT	TOTAL	WEIGHTED AVERAGE
Socialization for dogs	28.57% 14	12.24% 6	26.53% 13	14.29% 7	18.37% 9	49	2.82
Exercise and enrichment for dogs	28.57% 14	10.20% 5	20.41% 10	16.33% 8	24.49% 12	49	2.98
Socialization for humans	36.73% 18	4.08% 2	32.65% 16	10.20% 5	16.33% 8	49	2.65
Builds a sense of community	40.82% 20	4.08% 2	26.53% 13	10.20% 5	18.37% 9	49	2.61
Gives dogs a safe space to exercise and roam freely	27.08% 13	10.42% 5	25.00% 12	8.33% 4	29.17% 14	48	3.02
Improves desirability of Glencoe to potential buyers (newcomers)	54.00% 27	6.00% 3	24.00% 12	4.00% 2	12.00% 6	50	2.14



Survey Results

Q6 What concerns do you have for a dog park in the location shown on the rendering at the beginning of this survey? (Rate the strength of your opinion: 1 – no concern, 5 - high concern and 3 – neutral/ambivalent)

Answered: 49 Skipped: 4

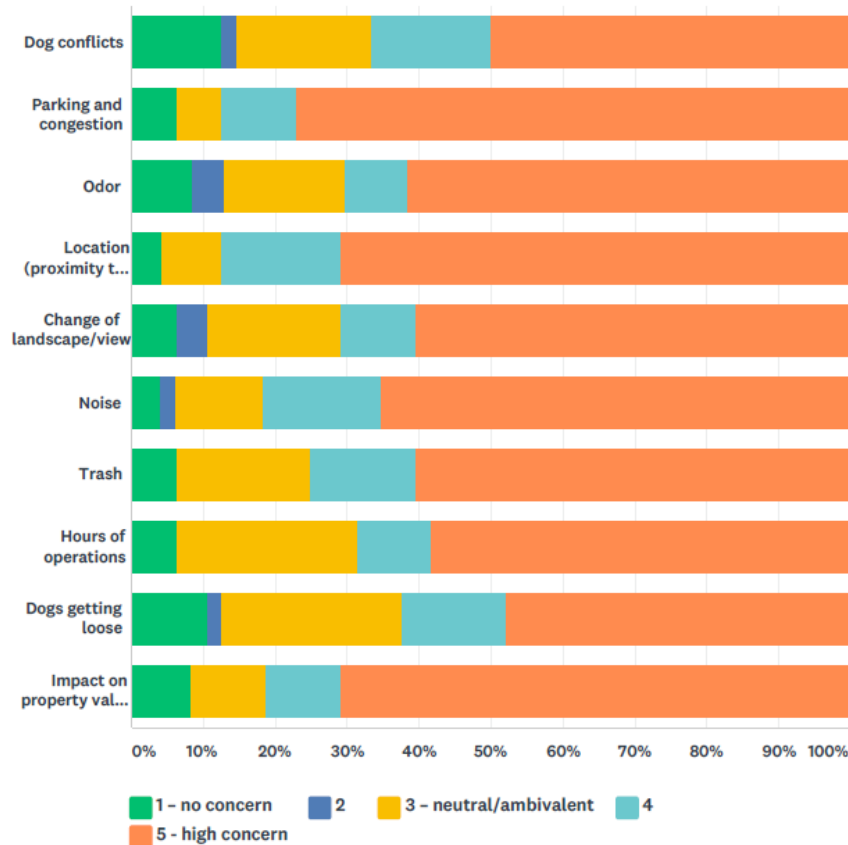

Survey Results

Q6 What concerns do you have for a dog park in the location shown on the rendering at the beginning of this survey? (Rate the strength of your opinion: 1 – no concern, 5 - high concern and 3 – neutral/ambivalent)

Answered: 49 Skipped: 4

	1 – NO CONCERN	2	3 – NEUTRAL/AMBIVALENT	4	5 - HIGH CONCERN	TOTAL	WEIGHTED AVERAGE
Dog conflicts	12.50% 6	2.08% 1	18.75% 9	16.67% 8	50.00% 24	48	3.90
Parking and congestion	6.25% 3	0.00% 0	6.25% 3	10.42% 5	77.08% 37	48	4.52
Odor	8.51% 4	4.26% 2	17.02% 8	8.51% 4	61.70% 29	47	4.11
Location (proximity to houses)	4.17% 2	0.00% 0	8.33% 4	16.67% 8	70.83% 34	48	4.50
Change of landscape/view	6.25% 3	4.17% 2	18.75% 9	10.42% 5	60.42% 29	48	4.15
Noise	4.08% 2	2.04% 1	12.24% 6	16.33% 8	65.31% 32	49	4.37
Trash	6.25% 3	0.00% 0	18.75% 9	14.58% 7	60.42% 29	48	4.23
Hours of operations	6.25% 3	0.00% 0	25.00% 12	10.42% 5	58.33% 28	48	4.15
Dogs getting loose	10.42% 5	2.08% 1	25.00% 12	14.58% 7	47.92% 23	48	3.88
Impact on property value for homes near dog park	8.33% 4	0.00% 0	10.42% 5	10.42% 5	70.83% 34	48	4.35



Survey Results

Q7 Would you support a dog park in the area shown on the rendering?

Answered: 52 Skipped: 1

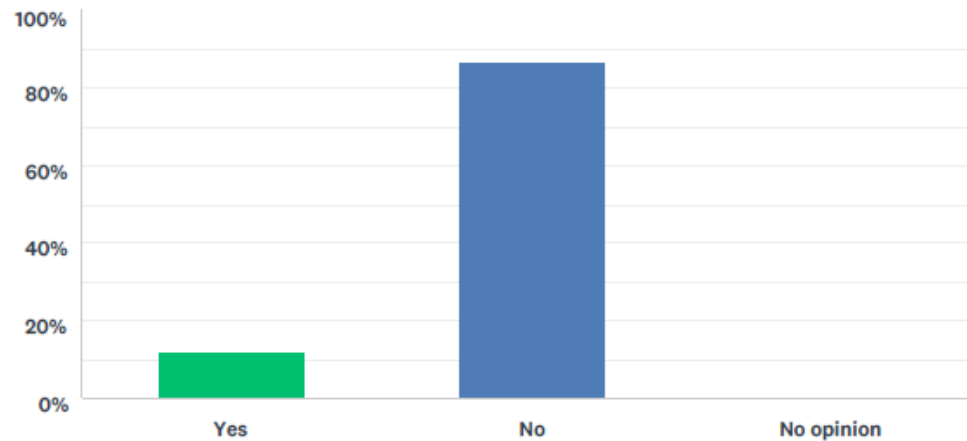

ANSWER CHOICES	RESPONSES	
Yes	11.54%	6
No	86.54%	45
No opinion	0.00%	0
Total Respondents: 52		



Want More Information?

Go to www.glencoe park district.com

Under News:

- <https://www.glencoe park district.com/news/special-projects/dog-park-feasibility>

You will find Task Force meeting packets and articles that were considered by the Task Force.

